

A TOWN BOARD MEETING was held on June 8, 2020, over Zoom, ID # 853 3296 6096, Password, # 352393. The location was from the comfort of everyone's home. Supervisor Wells called the meeting to order at 7:00 p.m. All said the Pledge of Allegiance. Supervisor Wells called for the Roll with the following Board Members answering.

Roll Call:	Councilman Mahone	Here
	Councilwoman Stanton	Here
	Councilwoman Curry	Here
	Councilman Rathbun	Here
	Supervisor Wells	Here

Minutes

Councilwoman Curry made a motion to accept the minutes of 5/11/20 and 5/19/20 as presented. Seconded by, Councilwoman Stanton. Councilwoman Stanton noticed that a sentence was missing in the last paragraph of 5/19/2020 in the minutes. This will be corrected.

Roll Call:	Councilman Mahoney	Aye
	Councilwoman Stanton	Aye
	Councilwoman Curry	Aye
	Councilman Rathbun	Aye
	Supervisor Wells	Aye

Department Head Reports/Additions

Supervisor Wells thanked Claudia Cunniff for sitting in on a webinar for him. Supervisor Wells thanked Pam Howard, Senior Account Clerk, for all her work, getting all the FEMA paperwork together. He stated she had saved the Town a lot of money doing this paperwork herself.

Discussion was held on the illegal dumping that residents are doing at the Parks and Rec. garage site. It was decided to start with putting up a sign stating there is NO DUMPING ALLOWED as well as putting up cameras.

Supervisor Wells let everyone know that the Transfer Station is now open at its regular hours.

Supervisor Wells thanked Kevin King for putting together a schedule allowing two men to get back to work at the Sewer and Water plants.

Councilwoman Stanton asked if the Community Action was fluid now. Supervisor Wells stated that it was. As all Towns have been working together, the demand for food is way down. Discussion held on the flower barrels at the Memorial Site. The CDC (Community Development Committee) have purchased the flowers for the two barrels at the site.

Supervisors Comments

SEQR Form: Supervisor Wells read the Negative Declaration page (SEQR) for the Blue Mt. Lake signage. SEQR attached herein. Supervisor Wells made a motion to approve the Negative Declaration form on the SEQR, for the Blue Mt. Lake signage. Seconded by, Councilman Rathbun.

Roll Call:	Councilman Mahoney	Aye
	Councilwoman Stanton	Aye
	Councilwoman Curry	Aye
	Councilman Rathbun	Aye
	Supervisor Wells	Aye

Supervisor Wells told all that Dr. Erica Mahoney, Director of the Hamilton County Department of Health would be holding another Cleaning and Disinfecting webinar. If anyone would like to attend, call, 518-648-6497.

Supervisor Wells reported to all that the 90 miler annual canoe race has been canceled.

Supervisor Wells reported to all that he had been handing out masks and hand sanitizer to the area businesses that are open.

Supervisor Wells reported to all that the CDC would be sending out another letter concerning the CENSUS. He thanked them for all their work.

Supervisor Wells asked if there had been any nominations for Citizen of the Year. There were no nominations this year. Supervisor Wells stated he would like to do it differently this year and have the Board mark this year's Citizen of the year as "2020 Year of the Volunteers". He stated there have been so many volunteers during this time and it is so appreciated he feels they all should be

acknowledged but due to the numerous volunteers it would be hard to list them all, therefore, mark it as 2020 year of the volunteers. Supervisor Wells made a motion to mark Citizen of the Year as "2020 Year of the Volunteers". Seconded by all!!!!!!

Supervisor Wells stated that he had received a letter of complaint from a second home homeowner complaining about the transfer station hours that was very offensive. He stated that there was NO intent from the Board to spite second home homeowners or any homeowner. All Board Members felt this was a very offensive letter, stating that they were trying to be equitable to ALL homeowners, second homeowners as well as full time residence. Supervisor Wells replied to the letter. Councilwoman Curry stated she would respond to the letter as well. She stated we value our second homeowners and the hours were not meant to slite anyone.

Supervisor Wells reported that he was working on the Electric Car Station, however, due to printer/scanning problems with his computer it is causing a hold up. He stated that he is working on getting the problem fixed.

Supervisor Wells stated he is working on the policy/procedure to begin opening the Town Hall. Supervisor Wells asked the Board their feelings about the 4th of July fireworks and reopening the Beaches. Due to the complexity of the regulations that need to be in place Supervisor Wells felt it was not feasible to open the Beaches this year. Among numerous regulations, Lifeguards would also need training on how to properly disinfect. The liability for the Town is extremely high and it will be a lot of responsibility for the Lifeguards to adhere to. Social distancing is mandatory and needs to be enforced, the number of people allowed on the Beach would need to be enforced, cleaning needs to be done every hour, testing patrons need to be done before entering the Beach and many more procedures need to be followed. Councilwoman Curry volunteered to meet with Bill Laprairie, Building Grounds and Maintenance Department Head, and Jessie Brusco, swim instructor, to go over all the regulations to see if it would be feasible to open this year.

Discussion was held on the 4th of July fireworks. Supervisor Wells read some of the regulations concerning fireworks. People would have to remain in their cars, no groups standing together, no bands allowed, no parades allowed and no activities. He stated that this would need to be strongly enforced. Councilman Mahoney felt that the residence was responsible and would adhere to the protocols put in place. He also felt that there would not be as much participation this year as he felt people are staying home. Supervisor Wells made a motion to cancel the 4th of July fireworks this year and perhaps have something later in the fall. Seconded by, Councilwoman Stanton.

Roll Call: Councilman Mahoney	Nay
Councilwoman Stanton	Aye
Councilwoman Curry	Aye
Councilman Rathbun	Aye
Supervisor Wells	Aye

Motion carried.

Councilman Rathbun offered setting off the canons at a certain time to commemorate 4th of July. Supervisor Wells stated that he thought that would be a good plan. He spoke of the "Taps Around America" that was done on Memorial Day. Councilman Rathbun and Supervisor Wells will meet and come up with a plan and time to set off the canons.

Supervisor Wells reported to the Board he had received two requests for building use. He stated to all that at this time, no Town owned Buildings are open at this time. He stated that the Town Board is still doing virtual meetings as well.

Supervisor Wells reported that he has been working with Peter Burns on the rafting program and contract. He stated that he is currently working on the safety plan for the "put in site".

Supervisor Wells reported to the Board that our Engineering Firm, Cedar Wood, are ready to begin moving forward on the water project in Blue Mt. He stated they would like to hire a subcontractor, Hydro Source, to begin working. He stated that Cedar Wood would be paying this Company themselves, this would come out of the money that Cedar Wood quoted us on. Councilwoman Stanton made a motion to allow Cedar Wood to move forward on the Blue Mt. Lake Water Project allowing the subcontractor. Seconded by, Councilman Rathbun.

Roll Call: Councilman Mahoney	Aye
Councilwoman Stanton	Aye
Councilwoman Curry	Aye
Councilman Rathbun	Aye
Supervisor Wells	Aye

The Board unanimously agreed to supply disinfectant spray and paper towels for the Board of Elections use on the June 23rd polling sites.

Supervisor Wells stated that he had a request for \$500.00 from the Shakespeare in the Park director. He

reported to the Board that it would be done virtually and due to the current Budget constraints, he felt this was an unneeded expense.

Supervisor Wells reported that Moose River Plans is now open.

Discussion was held on allowing Donald Liddle to give out transfer station stickers as well as handling the money and giving receipts to those needing to bring a refrigerator or air conditioner to the transfer site. This would stop the dropping off, of refrigerators while also keeping foot traffic down at the Town Hall building. The Board concurred. Councilwoman Curry suggested someone going over the procedures with Donald.

Other Town Business

Councilwoman Curry gave an update on the Weed District stating that Lance is working on his proposal to remove bogs. Supervisor Wells stated he had received Lances Certificate of Workman's Comp. Discussion held on TRP's. (Temporary Revocable Permit) from the State concerning the removal of bogs. Councilwoman Curry asked Darrin Harr about a walk through at Stewarts. Supervisor Wells explained that he had suggested it so the Chamber could get a feel on what they would need once allowed to go in. Councilwoman Curry thanked the CDC for the information they have been handing out. She also thanked Andy Coney and commended the Blue Mt. Lake Newsletter. She stated it was highly informative.

Discussion held on putting in the lights at the Blue Mt. Lake Restrooms. Supervisor Wells made a motion to work in conjunction with the Blue Mt. Lake Association to begin putting the lights in the restroom by the Blue Mt. Lake Fire Department. Seconded by, Councilwoman Stanton.

Roll Call: Councilman Mahoney	Aye
Councilwoman Stanton	Aye
Councilwoman Curry	Aye
Councilman Rathbun	Aye
Supervisor Wells	Aye

Andy Coney spoke to the Board concerning the two races that are held in Blue Mt. Lake annually. He reported to the Board that they are currently working on a safety plan to see if there is a way to hold them this year. He stated they were not going to cancel them until the last minute. Discussion was held. Councilwoman Curry stated that she felt they had a good handle on the situation. Andy assured the Board he would keep them updated.

Councilman Rathbun questioned Trash Day Pick Up. Discussion held. Supervisor Wells asked Jamie Roblee, Highway Superintendent, and Bill Laprairie, Building and Maintenance Department Head to put together a plan.

Councilman Rathbun reported that he had put the ribbons up around the daffodils and would begin digging them up when the time is right. He told all that he would let them know when and he would be in need of some volunteers.

Darrin Harr, Director of the Chamber of Commerce asked the Board when he could open the Chamber. He also questioned putting up signs so people will know that the Chamber is in the Byron Park Building temporarily. Supervisor Wells asked Darrin to put together his safety plan for reopening and get it to him, the Board will decide after going over the plan. Discussion held on signage. This will be worked on.

Pay Bills and Abstracts

Budget Transfers are attached herein.

26840 – 26935	\$76,153.10
26936 – 26949	\$1,040.64
26745 – 26751	\$190.55
26752 – 26756	\$189.99
26769 – 26770	\$191.19
26772 – 26808	\$8,036.54

Supervisor Wells made a motion to pay the Bills and Abstracts as presented. Seconded by, Councilwoman Stanton.

Roll Call: Councilman Mahoney	Aye
Councilwoman Stanton	Aye
Councilwoman Curry	Aye
Councilman Rathbun	Aye
Supervisor Wells	Aye

Building Maintenance and Operations monthly report May 2020

Things started off slow this month, with the return of three guys we are now a four-man crew. Employees have been using their own town vehicle as much as possible to help with social distancing, certain jobs require more than one man and we have been wearing masks provided to us by the town supervisor when we travel together or work on a project together.

The town of Indian Lake black fly program has gone on since the start of the pandemic with the Tim Clawson, Jeremiah DeLong or myself treating streams in both Blue and Indian lake. We have used about 40 gallons of product and with the warm temperatures and lack of water the program is starting to come to an end, we expect to be done in about two weeks.

We are starting to work on the library expansion project, we have taken out windows, doors and opened up the small vestibule area, inside we painted the hallway that leads to the new addition for Susan and have made three sneeze shields for the desks. Susan has ordered plexiglass and we will be creating a series of shields to go in between the computers so patrons will be less at risk of contacting any virus.

We have had a few wind storms this month and had to cut numerous down trees at Byron Park, we have turned the water on to the pavilion and the restrooms in preparation for summer use, we have mowed and raked outback and cleaned off the basketball courts so they can now be used.

Mowing season has started and everything has been hit once in Blue Mountain and Indian Lake. After the first go around we had a few issues with carburetors and small mechanical issues.

On rainy days we've pulled in our grooming equipment and started repairs on drags, adjusted the tracks cleaned out the tractors and made a few cosmetic repairs.

Pam Howard has been working hard to finish the FEMA reports from the Halloween storm, and we have had to go in the woods on all trails numerous times and get GPS coordinates of bridges, culverts, and washouts, all places where damage had occurred.

Trips have been made to North Creek, Glens Falls, and Speculator for parts. Beaver Brook outfitters collected silt fence that had washed down from the project on the Abanakee dam, we went down picked up a large truckload of debris at their shop and took care of it.

At the ski hut we have pushed off the stump dump numerous times this month after debris has been dumped there. We have taken down danger trees around the building, graded and ditched up along the rink after fall flooding washed out the bank, and we have cleaned up the yard.

Picnic tables, benches, and the lifeguard chairs have been brought to the beaches and stored until we are given the order to put them out.

The flower barrels were brought out and the garden club has gone through them and we put them out for planting.

Tennis nets are up in Blue Mountain, and we have put a pickle ball sign up that explains how to help prevent Covid by cleaning your equipment when you're done playing.

The speed limit signs have been put up in Blue Mountain, and we are looking into putting lights in the restrooms as soon as we catch up on a few other projects.

Thank you
Bill LaPrairie
Dept head Building Maintenance and Operations



Town of Indian Lake Water and Wastewater

Report for May 2020

Testing was completed at all plants daily.

Samples required by DEC and DOH were submitted to the lab.

The U.V. lights were put in at the sewer plant and turned on. DEC requires us to have the U.V. lights in the sewer effluent and on from May to October. The bulbs need to be cleaned weekly to keep up the required intensity of light.

There were several places in Blue Mt. Lake that had to be cleaned up from water breaks. These places were cleaned up and sunken blacktop was cut out and patched with gravel.

Seasonal water services were turned on for the summer in both Indian Lake and Blue Mt. Lake.

There was debris from a water break on the end of Sawmill Rd. that was cleaned up.

At Blueline Electric there were two curb stops that we dug up and fixed.

We had two new hydrants delivered to Indian Lake. We are going to replace one in Indian lake and one in Blue Mt. Lake.

Hydrants were flushed in Blue Mt. Lake.

There was a problem with the radio signal at the Indian Lake Water Plant. The radio signal tells the water plant how much water is in the water tank, and was not communicating with the computer in the Water Plant. Once we found ^{THE PROBLEM} ~~we got our~~ we got our signal back.

There was a valve box on Bennett Rd. that the frost had pushed up in someone's driveway that we dug up and fixed.

Thank-You



Kevin King/Water and Sewer superintendent

MECHANIC'S MONTHLY REPORT

FOR May 2020

SUBMITTED BY: BILL WELLS

- Serviced and installed broom on # 5085 tractor
- Complete service on # 193 loader
- Mounted tire on # 186
- Repaired hoses for broom on # 3320 tractor
- Changed flat tire on # 191 pick-up
- Serviced # 181 1-ton pick-up
- Installed new wafers on pick-up broom
- Put new tire on rim for # 186
- Replaced mail hydraulic hose on # 182
- Full service completed on # 186 dump truck
- Rebuilt rod for # 186 blade steering
- Installed new wafers on tow broom
- Fixed battery for # 3320 tractor
- Put another new tire on rim for # 186

Highway Report
June 2020

The highway dept has been busy doing cleanup from the wind and ice storms that occurred over the winter. Most roads have been cleaned of brush and trees and washed to our stump dump at the Sk. Mt.

Stone piles are being replenished from what was used to repair roads after the Halloween Storm 2019.

Stone is being hauled for our chip seal projects in Blue Mt. and Indian Lake.

Moose River Plains will be opened today for Public Traffic. There were

a couple wrecks from the Halloween Storm that needed to be fixed. Soft Road conditions did not allow us to do this until this week.

Most dirt Roads have been graded and washed during the last month.

All roads have been swept to remove the winter sand.

We will start patching potholes in the near future.

Dawnie Robblee
Highway Supt.



TOWN OF INDIAN LAKE
 P.O. Box 730 Pelton Road
 Indian Lake, Hamilton County
 New York 12842

 **COPY**

Town of Indian Lake Building Permit Report
May 2020

	<u>Residential</u>	<u>Commercial</u>
1. Total # of Permits Issued:	8	1
2. Total dollar amount of projects in #1:	<u>\$199,100</u>	<u>\$10,000</u>
3. Number of Permits in #1 which are Hunting Camps:	1	
4. Total dollar amounts of projects in #3:	<u>\$3800</u>	
5. Number of single-family permits issued (Camps N/A):	1	
6. Total dollar amount of projects in #5:	<u>\$39,200</u>	
7. Number of Trailers/Double Wide/Modular Homes:	<u>0</u>	
8. Number of Permit renewals:	<u>0</u>	
9. Number of Firework Permits issued:	<u>0</u>	
10. Total dollar amount of permits in #9:	<u>\$0</u>	
11. Fire inspections (Annual) to date	3	

Respectfully Submitted by:

 Tyler Montthony

Indian Lake Chamber of Commerce
 Board of Directors
 May 14, 2020

Board Members Present: Nick LaScala, David Oestreicher, Carolyn DeVito, Cassie Marion, Brenda Valentine, Kathleen Peartree Moon, Sherry Williams, Sue Montgomery Corey

Staff Present: Darrin Harr

Meeting convened at 5:05 PM.

Kathleen Peartree Moon made a motion, seconded by Carolyn DeVito to approve the agenda. The motion was carried.

Minutes from the April 9 meeting were reviewed. Motion made by Carolyn DeVito, seconded by Brenda Valentine to approve. Motion was carried.

Financial report for May 1-13 was reviewed. Carolyn DeVito moved to approve, seconded by Sue Montgomery Corey and carried.

Cassie Marion recommended that the Chamber look into workers comp coverage with the NYS Insurance Fund. Darrin Harr noted that the Chamber currently has its workers comp policy with The Hartford. Current bill is \$268.

Darrin Harr followed up on the Stewart's grant application. They are still reviewing. He also followed up on the EIDL loan application with an email to their customer service.

Darrin Harr and Carolyn DeVito developed some projections for the Chamber's financial situation. They will develop at least one more projection based on a worst case scenario. Among the considerations: cancellation of the Moose Festival and Annual Dinner.

Darrin Harr and Sue Montgomery Corey shared the plans for the Legislative Forum on Friday. At this point approximately 12 people have signed up. Brenda Valentine agreed to reach out to Brian Wells and Bill Farber.

Brenda Valentine provided an update on the Stewart's project and relocation of the Chamber. She reported that Brian Wells advises that the Chamber should pack for the move to Byron Park. Chamber should plan to bring its own phone. Darrin Harr agreed to have Chamber calls forwarded to his cell phone. Wifi will be available as will other utilities. Bill LaPrairie of Parks and Rec will help move desks and filing cabinets. Signs from Chamber building will need to be moved.

It was suggested by David Oestreicher that the Chamber do a walk around at the old Stewarts at some point to brainstorm about how best to make the new facilities work for us.

Carolyn DeVito and Darrin Harr provided an update on the masks and tote bags. Tote bags are coming next week. Kathleen Peartree Moon developed a great draft for the appeal to potential sponsors. Carolyn has ordered gloves for the bags. Masks were donated. Some will go in the bags. The remainder are available for businesses that will need them.

Darrin Harr noted that the State Dept. of Environmental Conservation will be changing out the technology used for printing NYS Decals. The change will be phased. As a smaller user of the technology, the Chamber will not receive the new printer immediately which will negatively impact our ability to sell Decals, fishing licenses. This will kick in on May 31.

Reopening of NY was discussed. It was noted that the North Country Chamber will be doing trainings for various sectors. The question was raised about when the Chamber office can reopen to the public and what cleaning equipment would be needed. It appears that the administrative function of the Chamber should be phase 2. Curbside retail is phase 1.

The summer sports expo has been cancelled for May 23, 24. Darrin is trying to get our \$630 registration fee refunded.

The Board decided to move forward with the Scholarships for this year. Donations have been arranged to cover the \$500 cost. Sue Montgomery Corey will finalize the application with the comments received, send to Darrin Harr who will work with Genine Longacker at Indian Lake Central School. The return date on the scholarships is June 1.

The Board agreed to keep meeting weekly.

ALL RIGHTS RESERVED. COPY OR REPRODUCTION OF THIS DRAWING OR DOCUMENT, IN ANY POSITION, IN WHOLE OR IN PART, WITHOUT THE EXPRESS WRITTEN PERMISSION OF CHASEN ENGINEERING, LAND SURVEYING, LANDSCAPE ARCHITECTURE AND PLANNING IS STRICTLY PROHIBITED. THIS DRAWING OR DOCUMENT IS NOT INTENDED OR REPRESENTED TO BE SUITABLE FOR ANY PURPOSE OTHER THAN THE SPECIFIC PROJECT, APPLICATION AND SITUATION FOR WHICH IT WAS PREPARED. ANY MODIFICATION, DELETION, ADDITION, OR ALTERATION OF THIS DRAWING OR DOCUMENT WITHOUT THE WRITTEN PERMISSION OF CHASEN ENGINEERING, LAND SURVEYING & URBAN DESIGN IS STRICTLY PROHIBITED. CHASEN ENGINEERING, LAND SURVEYING & URBAN DESIGN IS NOT RESPONSIBLE FOR ANY DAMAGE, LOSS, OR INJURY TO PERSONS OR PROPERTY, OR ANY OTHER CONSEQUENCES THAT MAY BE INCURRED AS A RESULT OF THE USE OF THIS DRAWING OR DOCUMENT. THE DESIGN PROFESSIONAL SHALL BE RESPONSIBLE FOR THE DESIGN AND CONSTRUCTION OF ANY SUCH ALTERATION AND A SEPARATE DESIGN SHALL BE REQUIRED FOR ANY SUCH ALTERATION. THE DESIGN PROFESSIONAL SHALL BE RESPONSIBLE FOR THE DESIGN AND CONSTRUCTION OF ANY SUCH ALTERATION.

Short Environmental Assessment Form
Blue Mountain Lake Signage

CONTENTS

PROJECT DESCRIPTION

SHORT ENVIRONMENTAL ASSESSMENT FORM PART 1 WITH ENDNOTES

FIGURES

- Figure 1: Orthophoto Location Map
- Figure 2: USGS Location Map – Sign 1 (Rt. 30 and Rt. 28)
- Figure 3: USGS Location Map – Sign 2 (Rt. 28)
- Figure 4: USGS Location Map – Sign 3 (Rt. 28 N and Rt. 30)
- Figure 5: Land Use Map
- Figure 6: NYSOPRHP Cultural Resource Information System (CRIS) Map
- Figure 7: Wetlands and Streams Map
- Figure 8: NYSDEC Environmental Resource Map

ATTACHMENTS

- Attachment A: USFWS IPaC Trust Resource Report (or official species list)
- Attachment B: SHPO Consultation Letter
- Attachment C: Proposed Sign Design

Short Environmental Assessment Form Part 1

Town of Indian Lake

Blue Mountain Lake Signage

Town of Indian Lake
Hamilton County, New York

February 24, 2020

THE



Proud to be Employee Owned

Engineers
Land Surveyors
Planners
Environmental Professionals
Landscape Architects

The Chazen C
Februon,

Short Environmental Assessment Form
Blue Mountain Lake Signage

PROJECT DESCRIPTION

The Chazen C
Februon)

Short Environmental Assessment Form
Blue Mountain Lake Signage

PROJECT DESCRIPTION

The Applicant, the Town of Indian Lake, is proposing the construction of three signs, of 4.5' x 6' e; separate locations in the Town of Indian Lake. All portions of the project site(s) are to take plac NYS Department of Transportation (NYS DOT) right-of-way (ROW). The project locations follows: Sign 1 on Rt. 30 (approximately .5 miles south of the Rt.30/Rt. 28 and I intersection) and Rt. 28, Sign 2 on Rt:28 (approximately 1.20 miles west of the Rt. 28 and Rt. 28n intersection), and Sign 3 on Rt. 28N and Rt. 30 (approximately 1.3 north of the Rt.30/Rt. 28 and Rt. 28n intersection).

The proposed project includes the removal of the current signage and the installation signage. Approximately 20 square feet of disturbance per sign is to be expected. For the f of this Short Environmental Assessment Form (SEAF), the project area is defined by the lo listed above as Signs 1, 2, and 3.

Sign 1 is situated in the Town of Indian Lake's Forest Preserve Zoning District. Sign 2 is situate Other Conserved Land Zoning District. Sign 3 is situated in the Rural Residential 8.5-acre (RR) District. The proposed project is a permitted use within the project area and will not conflict v related ROW.

The SEAF was partially completed by the NYSDEC EAF Mapper. Endnotes are provided for some re to provide clarification of or reference used for the response.

The Chazen C
Februan

Short Environmental Assessment Form
Blue Mountain Lake Signage

Part 1

SHORT ENVIRONMENTAL ASSESSME FORM (SEAF) PART 1 WITH ENDNO

The Chazen C
Februan

Short Environmental Assessment Form Part 1 - Project Information

Instructions for Completing

Part 1 - Project Information. The applicant or project sponsor is responsible for the completion of Part 1. Responses be application for approval or funding, are subject to public review, and may be subject to further verification. Complete information currently available. If additional research or investigation would be needed to fully respond to any item.

thoroughly as possible based on current information.

Complete all items in Part 1. You may also provide any additional information which you believe will be needed by the lead agency; attach additional pages as necessary to supplement any item.

Part 1 – Project and Sponsor Information

Town of Indian Lake, NY

Name of Action or Project:

Blue Mountain Lake Signage

Project Location (describe, and attach a location map): See Figures 1.2,3,4.

3 signs at different locations (Rt. 30, Rt. 28 and Rt. 28n)

Brief Description of Proposed Action: See Attachment C: Proposed Sign Design

The Town of Indian Lake is proposing three new signs, to replace current signage, for the hamlet of Blue Mountain Lake. The purpose is to provide way-finding for visitors and to attract tourism to the area and its attractions. The signs are proposed for the following locations: (1) coming from the hamlet of Indian Lake, (2) Rt. 28 coming from Inlet/Old Forge, and (3) Rt. 28N coming from Long Lake, and All the same artwork and writing. They will say "Blue Mountain Lake, Home of the Adirondack's Largest Museum and the Adirondack's Center". The proposed signs will have 12'10" tall posts with two panels, one being 4.5 x 5' and one being 4.5 x 1'. The signs will be wood or 16gg aluminum with matte over laminate. The footprint of the new signs will remain the same as the current signs. The sign anticipated to have an adverse impacts on any cultural, historical or environmental resources.

Name of Applicant or Sponsor:

Brian Wells, Town of Indian Lake Supervisor

Telephone: 518-648-5211

E-Mail: blsuper@gmail.com

Address:

PO Box 730, 117 Pelton Road

City/PO:

Town of Indian Lake

State:

NY

Zip Code:

12842

- Does the proposed action only involve the legislative adoption of a plan, local law, ordinance, administrative rule, or regulation?
If Yes, attach a narrative description of the intent of the proposed action and the environmental resources that may be affected in the municipality and proceed to Part 2. If no, continue to question 2.
- Does the proposed action require a permit, approval or funding from any other government Agency?
If Yes, list agency(s) name and permit or approval: NYS Department of Transportation

- Total acreage of the site of the proposed action? _____ acres
 - Total acreage to be physically disturbed? <0.001 acres
 - Total acreage (project site and any contiguous properties) owned or controlled by the applicant or project sponsor? _____ acres

- Check all land uses that occur on, are adjoining or near the proposed action. See Figure 5.
 - Urban Rural (non-agriculture) Industrial Commercial Residential (suburban)
 - Forest Agriculture Aquatic Other (Specify): Recreation and Residential
 - Parkland

- Is the proposed action.
 - Permitted use under the zoning regulations?
 - Consistent with the adopted comprehensive plan?

6. Is the proposed action consistent with the predominant character of the existing built or natural landscape?

7. Is the site of the proposed action located in, or does it adjoin, a state listed Critical Environmental Area?
If Yes, identify: _____

8. Will the proposed action result in a substantial increase in traffic above present levels?

a. Are public transportation services available at or near the site of the proposed action?

b. Are any pedestrian accommodations or bicycle routes available on or near the site of the proposed action?

9. Does the proposed action meet or exceed the state energy code requirements?
If the proposed action will exceed requirements, describe design features and technologies: _____

10. Will the proposed action connect to an existing public/private water supply?
If No, describe method for providing potable water: _____

N/A

11. Will the proposed action connect to existing wastewater utilities?
If No, describe method for providing wastewater treatment: _____

N/A

12. a. Does the project site contain, or is it substantially contiguous to, a building, archaeological site, or district which is listed on the National or State Register of Historic Places, or that has been determined by the Commissioner of the NYS Office of Parks, Recreation and Historic Preservation to be eligible for listing on the State Register of Historic Places? See Endnote 5 and Figure 6.
Sign 2 is next to a building that is on the National and State Register of Historic Places. Sign 3 is in an archaeological sensitive area

b. Is the project site, or any portion of it, located in or adjacent to an area designated as sensitive for archaeological sites on the NY State Historic Preservation Office (SHPO) archaeological site inventory?

13. a. Does any portion of the site of the proposed action, or lands adjoining the proposed action, contain wetlands or other waterbodies regulated by a federal, state or local agency? See Endnote 3 and Figure 7.

b. Would the proposed action physically alter, or encroach into, any existing wetland or waterbody?
If Yes, identify the wetland or waterbody and extent of alterations in square feet or acres: _____

14. Identify the typical habitat types that occur on, or are likely to be found on the project site. Check all that apply
- Shoreline Forest Agricultural/grasslands Early mid-successional
- Wetland Urban Suburban

15. Does the site of the proposed action contain any species of animal, or associated habitats, listed by the State or Federal government as threatened or endangered? See Endnote 4 and Figure 8.

16. Is the project site located in the 100-year flood plain?

17. Will the proposed action create storm water discharge, either from point or non-point sources?
If Yes,

- a. Will storm water discharges flow to adjacent properties?
- b. Will storm water discharges be directed to established conveyance systems (runoff and storm drains)?
If Yes, briefly describe:

18. Does the proposed action include construction or other activities that would result in the impoundment of water or other liquids (e.g., retention pond, waste lagoon, dam)?
If Yes, explain the purpose and size of the impoundment:

19. Has the site of the proposed action or an adjoining property been the location of an active or closed solid waste management facility?
If Yes, describe:

20. Has the site of the proposed action or an adjoining property been the subject of remediation (ongoing or completed) for hazardous waste?
If Yes, describe:

I CERTIFY THAT THE INFORMATION PROVIDED ABOVE IS TRUE AND ACCURATE TO THE BEST OF MY KNOWLEDGE

Applicant/sponsor/name: Brian Wells

Signature: *Brian Wells*

Title: Town of Indian Lake Supervisor

Date: *6-8-2020*

Julia A. Dawson - 6/8/2020
Antonia P. Hae - Supervisor

JULIE A. CLARKSON
NOTARY PUBLIC, STATE OF NEW YORK
COUNTY OF WASHINGTON COUNTY
NO. 0123456789

Agency Use Only (If applicable)
Project: _____
Date: _____

Short Environmental Assessment Form
Part 2 - Impact Assessment

Part 2 is to be completed by the Lead Agency.

Answer all of the following questions in Part 2 using the information contained in Part 1 and other materials submitted by the project sponsor or otherwise available to the reviewer. When answering the questions the reviewer should be guided by the concept "Have my responses been reasonable considering the scale and context of the proposed action?"

	No. or small impact may occur	Moderate to large impact may occur
1. Will the proposed action create a material conflict with an adopted land use plan or zoning regulations?	<input checked="" type="checkbox"/>	<input type="checkbox"/>
2. Will the proposed action result in a change in the use or intensity of use of land?	<input checked="" type="checkbox"/>	<input type="checkbox"/>
3. Will the proposed action impair the character or quality of the existing community?	<input checked="" type="checkbox"/>	<input type="checkbox"/>
4. Will the proposed action have an impact on the environmental characteristics that caused the establishment of a Critical Environmental Area (CEA)?	<input checked="" type="checkbox"/>	<input type="checkbox"/>
5. Will the proposed action result in an adverse change in the existing level of traffic or affect existing infrastructure for mass transit, biking or walkway?	<input checked="" type="checkbox"/>	<input type="checkbox"/>
6. Will the proposed action cause an increase in the use of energy and it fails to incorporate reasonably available energy conservation or renewable energy opportunities?	<input checked="" type="checkbox"/>	<input type="checkbox"/>
7. Will the proposed action impact existing: a. public / private water supplies? b. public / private wastewater treatment utilities?	<input checked="" type="checkbox"/>	<input type="checkbox"/>
8. Will the proposed action impair the character or quality of important historic, archaeological, architectural or aesthetic resources?	<input checked="" type="checkbox"/>	<input type="checkbox"/>
9. Will the proposed action result in an adverse change to natural resources (e.g., wetlands, waterbodies, groundwater, air quality, flora and fauna)?	<input checked="" type="checkbox"/>	<input type="checkbox"/>
10. Will the proposed action result in an increase in the potential for erosion, flooding or drainage problems?	<input checked="" type="checkbox"/>	<input type="checkbox"/>
11. Will the proposed action create a hazard to environmental resources or human health?	<input checked="" type="checkbox"/>	<input type="checkbox"/>

PRINT FORM

Agency Use Only [If applicable]

Project: _____

Date: _____

Short Environmental Assessment Form
Part 3 Determination of Significance

For every question in Part 2 that was answered "moderate to large impact may occur" or if there is a need to explain why a particular element of the proposed action may or will not result in a significant adverse environmental impact, please complete Part 3. Part 3 should, in sufficient detail, identify the impact, including any measures or design elements that have been included by the project sponsor to avoid or reduce impacts. Part 3 should also explain how the lead agency determined that the impact may or will not be significant. Each potential impact should be assessed considering its setting, probability of occurring, duration, irreversibility, geographic scope and magnitude. Also consider the potential for short-term, long-term and cumulative impacts.

The proposed project is not anticipated to have any significant adverse environmental impacts. The proposed signs will have the same footprint (20 square feet for each sign) as the current signs. The proposed signs will have 12"10" tall posts with two panels, one being 4.5' x 5' and one being 4.5' x 1'. The signs will be made of painted wood or 16gg aluminum with matte over laminate.

The purpose of the signs is to provide way-finding for visitors and to attract tourism to the area and its attractions. The signs are proposed for the following locations: (1) Rt. 30 coming from the hamlet of Indian Lake, (2) Rt. 28 coming from Inlet/Old Forge, and (3) Rt. 28N coming from Long Lake, and. All three signs will have the same artwork and writing. They will say "Blue Mountain Lake, Home of the Adirondack's Largest Museum and the Adirondack's Oldest Arts Center".

Check this box if you have determined, based on the information and analysis above, and any supporting documentation, that the proposed action may result in one or more potentially large or significant adverse impacts and an environmental impact statement is required.

Check this box if you have determined, based on the information and analysis above, and any supporting documentation, that the proposed action will not result in any significant adverse environmental impacts.

Town of Indian Lake
 Name of Lead Agency: _____
 Brian Wells
 Name of Responsible Officer in Lead Agency: _____
 Signature of Responsible Officer in Lead Agency: *Brian E. Wells*
 Title of Responsible Officer: _____
 Signature of Preparer (if different from Responsible Officer): _____
 Date: *6-8-2020*

PRINT FORM

PRINT FORM

Short Environmental Assessment Form
Blue Mountain Lake Signage

ENDNOTES

1. Project Location

The project site(s) include 3 locations in the Town of Indian Lake, upon entrance to the hamlet Mountain Lake. All portions of the project site(s) are to take place in the NYS Department of Transportation (NYS DOT) right-of-way (ROW). The project locations are as follows: Sign 1 on (approximately .5 miles south of the Rt.30/Rt. 28 and Rt. 28n intersection) and Rt. ; 2 on Rt.28 (approximately 1.20 miles west of the Rt.30/Rt. 28 and Rt. 28n intersect Sign 3 on Rt. 28N and Rt. 30 (approximately 1.35 miles north of the Rt.30/Rt. 28 and intersection). Please see Attachment C: Proposed Sign Design.

2. Wetlands and Surface Waters

According to NYS Department of Environmental Conservation (NYSDEC) EAF Mapper, the Environmental Resource Mapper, and GIS mapping, the site of Sign 1 is within the vicinity of a 1 Wetland Inventory wetland. The wetland is identified as a Freshwater Forested/Shrub 1 habitat encompassing 2.52 acres. However, the project is well within the limit of the road and will not have any impacts to the wetlands. There are no NYSDEC regulated wetland or st National Wetland Inventory (NWI) wetland found on or contiguous to the other Sign locati proposed project is not anticipated to have any adverse impacts on the identified wetlands refer to Figure 7, *Wetlands and Streams Map*, and Figure 8, *NYSDEC Environmental Resource*

3. Cultural/Historic Resources

According to the NYS Office of Parks, Recreation, and Historic Preservation (NYSOPRHP) Resource Information System (CRIS) mapping (Figure 6), the project site of Sign 2 is located to a National and State Historic Site known as the Hedges. Sign 3 is located within a archaeological sensitive area. Please note Sign 2 would not be visible from the Hedges a signs are located within the adjoining roadway where there is existing infrastructure and f ground disturbances. Project information has been uploaded to the NYSOPRHP CRIS requesting review of the proposed project.

The Chazen C
February

ATTACHMEN

USFWS IPac Trust Resource Rep

The Chazen C
February

IPac

U.S. Fish &

IPac resource list

This report is an automatically generated list of species and other resources such as criti (collectively referred to as *trust resources*) under the U.S. Fish and Wildlife Service's (USF that are known or expected to be on or near the project area referenced below. The list i trust resources that occur outside of the project area, but that could potentially be direct affected by activities in the project area. However, determining the likelihood and extent project may have on trust resources typically requires gathering additional site-specific (i vegetation/species surveys) and project-specific (e.g., magnitude and timing of proposed information.

Below is a summary of the project information you provided and contact information for (affixed) with jurisdiction in the defined project area. Please read the introduction to part

information applicable to the trust resources addressed in that section.

Location

Hamilton County, New York



Local office

New York Ecological Services Field Office

☎ (607) 753-9334

📠 (607) 753-9699

3817 Luker Road

Cortland, NY 13045-9385

<http://www.fws.gov/northeast/nyfo/es/section7.htm>

Endangered species

This resource list is for informational purposes only and does not constitute an analytical impact.

The primary information used to generate this list is the known or expected range of each species. Additional areas of influence (AOI) for species are also considered. An AOI includes areas where a species range if the species could be indirectly affected by activities in that area (e.g., plan

upstream of a fish population, even if that fish does not occur at the dam site, may indirectly affect a species by reducing or eliminating water flow downstream). Because species can move, conditions can change, the species on this list are not guaranteed to be found on or near the area. To fully determine any potential effects to species, additional site-specific and project information is often required.

Section 7 of the Endangered Species Act requires Federal agencies to "request of the Secretary information whether any species which is listed or proposed to be listed may be present in such proposed action" for any project that is conducted, permitted, funded, or licensed by the agency. A letter from the local office and a species list which fulfills this requirement can be requested from either the Regulatory Review section in IPAC (see below) or from the local field office directly.

For project evaluations that require USFWS concurrence/review, please return to the IPAC request an official species list by doing the following:

1. Draw the project location and click CONTINUE.
2. Click DEFINE PROJECT.
3. Log in (if directed to do so).
4. Provide a name and description for your project.
5. Click REQUEST SPECIES LIST.

Listed species¹ and their critical habitats are managed by the Ecological Services Program and Wildlife Service (USFWS) and the fisheries division of the National Oceanic and Atmospheric Administration (NOAA Fisheries²).

Species and critical habitats under the sole responsibility of NOAA Fisheries are not shown. Please contact NOAA Fisheries for species under their jurisdiction.

1. Species listed under the Endangered Species Act are threatened or endangered; IPAC species that are candidates, or proposed, for listing. See the listing status page for more information.
2. NOAA Fisheries, also known as the National Marine Fisheries Service (NMFS), is an offshoot of the National Oceanic and Atmospheric Administration within the Department of Commerce.

THERE ARE NO ENDANGERED SPECIES EXPECTED TO OCCUR AT THIS LOCATION.

Migratory birds

Certain birds are protected under the Migratory Bird Treaty Act¹ and the Bald and Golden Eagle Protection Act².

Protection Act².

Any person or organization who plans or conducts activities that may result in impacts to eagles, and their habitats should follow appropriate regulations and consider implementation conservation measures, as described below.

1. The Migratory Birds Treaty Act of 1918.
2. The Bald and Golden Eagle Protection Act of 1940.

Additional information can be found using the following links:

- Birds of Conservation Concern <http://www.fws.gov/birds/management/managed-species-of-conservation-concern.php>
- Measures for avoiding and minimizing impacts to birds <http://www.fws.gov/birds/management/project-assessment-tools-and-guidance/conservation-measures.php>
- Nationwide conservation measures for birds <http://www.fws.gov/migratorybirds/pdf/management/nationwidestandardsconservation/>

The birds listed below are birds of particular concern either because they occur on the U.S. Conservation Concern (BCC) list or warrant special attention in your project location. To help you understand the levels of concern for birds on your list and how this list is generated, see the [FAQ](#) below. To help you understand the list of every bird you may find in this location, nor a guarantee that every bird on this list is your project area. To see exact locations of where birders and the general public have sightings and around your project area, visit the [E-bird data mapping tool](#) (Tip: enter your location range and a species on your list). For projects that occur off the Atlantic Coast, additional models detailing the relative occurrence and abundance of bird species on your list are available. Additional information about Atlantic Coast birds, and other important information about bird list, including how to properly interpret and use your migratory bird report, can be found [here](#).

For guidance on when to schedule activities or implement avoidance and minimization to reduce impacts to migratory birds on your list, click on the **PROBABILITY OF PRESENCE** section at the top of your list to see when these birds are most likely to be present and breeding in your project area.

BREEDING SEASON IS INDICATED BY A GREEN BAR ON YOUR LIST, THE COLOR OF THE BAR INDICATES THE PROBABILITY OF PRESENCE IN YOUR PROJECT AREA. THE PROBABILITY OF PRESENCE IS INDICATED BY A GREEN BAR ON YOUR LIST, THE COLOR OF THE BAR INDICATES THE PROBABILITY OF PRESENCE IN YOUR PROJECT AREA. THE PROBABILITY OF PRESENCE IS INDICATED BY A GREEN BAR ON YOUR LIST, THE COLOR OF THE BAR INDICATES THE PROBABILITY OF PRESENCE IN YOUR PROJECT AREA.

PROBABILITY OF PRESENCE

THAT THE BIRD DOES NOT BREED IN YOUR PROJECT AREA

Breeds Dec 1 to

Bald Eagle *Haliaeetus leucocephalus*
This is not a Bird of Conservation Concern (BCC) in this area, but warrants attention because of the Eagle Act or for potential susceptibilities in offshore areas from certain types of development or activities.
<https://ecos.fws.gov/ecp/species/1626>

Breeds Jun 10 to

Bicknell's Thrush *Catharus bicknelli*
This is a Bird of Conservation Concern (BCC) throughout its range in the continental USA and Alaska.
<https://ecos.fws.gov/ecp/species/606>

Breeds May 20 to

Canada Warbler *Cardellina canadensis*
This is a Bird of Conservation Concern (BCC) throughout its range in the continental USA and Alaska.

Breeds Jun 1 to

Cape May Warbler *Setophaga tigrina*
This is a Bird of Conservation Concern (BCC) throughout its range in the continental USA and Alaska.

Breeds May 10 to

Wood Thrush *Hylocichla mustelina*
This is a Bird of Conservation Concern (BCC) throughout its range in the continental USA and Alaska.

Probability of Presence Summary

The graphs below provide our best understanding of when birds of concern are most likely to be present in your project area. This information can be used to tailor and schedule your project activities to minimize impacts to birds. Please make sure you read and understand the FAQ "Proper Use of Your Migratory Bird Report" before using or attempting to interpret this report.

Probability of Presence (●)

Each green bar represents the bird's relative probability of presence in the 10km grid cell overlaps during a particular week of the year. (A year is represented as 12 4-week month intervals). A higher probability of species presence. The survey effort (see below) can be used to indicate a level of confidence in the presence score. One can have higher confidence in the presence score.

corresponding survey effort is also high.

How is the probability of presence score calculated? The calculation is done in three steps

1. The probability of presence for each week is calculated as the number of survey events where the species was detected divided by the total number of survey events for that example, if in week 12 there were 20 survey events and the Spotted Towhee was four the probability of presence of the Spotted Towhee in week 12 is 0.25.

2. To properly present the pattern of presence across the year, the relative probability is calculated. This is the probability of presence divided by the maximum probability of all weeks. For example, imagine the probability of presence in week 20 for the Spotted and that the probability of presence at week 12 (0.25) is the maximum of any week of relative probability of presence on week 12 is $0.25/0.25 = 1$; at week 20 it is $0.05/0.25 = 0.2$.
3. The relative probability of presence calculated in the previous step undergoes a statistic so that all possible values fall between 0 and 10, inclusive. This is the probability of presence so that all possible values fall between 0 and 10, inclusive. This is the probability of presence

To see a bar's probability of presence score, simply hover your mouse cursor over the bar

Breeding Season ()

Yellow bars denote a very liberal estimate of the time-frame inside which the bird breeds; range. If there are no yellow bars shown for a bird, it does not breed in your project area

Survey Effort (|)

Vertical black lines superimposed on probability of presence bars indicate the number of surveys performed for that species in the 10km grid cell(s) your project area overlaps. The number is expressed as a range, for example, 33 to 64 surveys.

To see a bar's survey effort range, simply hover your mouse cursor over the bar.

No Data (-)

A week is marked as having no data if there were no survey events for that week.

Survey Timeframe

Surveys from only the last 10 years are used in order to ensure delivery of currently relevant data. The exception to this is areas off the Atlantic coast, where bird returns are based on all y data, since data in these areas is currently much more sparse.



warrants attention because of the Eagle Act or for potential susceptibilities in offshore areas from certain types of development or activities.)

Bicknell's Thrush
BCC Rangelwide (CON)
(This is a Bird of Conservation Concern (BCC) throughout its range in the continental USA and Alaska.)

Canada Warbler
BCC Rangelwide (CON)
(This is a Bird of Conservation Concern (BCC) throughout its range in the continental USA and Alaska.)

Cape May Warbler
BCC Rangelwide (CON)
(This is a Bird of Conservation Concern (BCC) throughout its range in the continental USA and Alaska.)

Wood Thrush
BCC Rangelwide (CON)
(This is a Bird of Conservation Concern (BCC) throughout its range in the continental USA and Alaska.)

Tell me more about conservation measures I can implement to avoid or minimize impacts to migratory birds.

Nationwide Conservation Measures describes measures that can help avoid and minimize impacts to location year round. Implementation of these measures is particularly important when birds are most the project area. When birds may be breeding in the area, identifying the locations of any active nests destruction is a very helpful impact minimization measure. To see when birds are most likely to occur your project area, view the Probability of Presence Summary. Additional measures and/or permits may be required depending on the type of activity you are conducting and the type of infrastructure or bird species project site.

What does IPaC use to generate the migratory birds potentially occurring in my specified location?

The Migratory Bird Resource List is comprised of USFWS [Birds of Conservation Concern \(BCC\)](#) and other warrant special attention in your project location.

The migratory bird list generated for your project is derived from data provided by the Avian Knowledge Network (AKN) data is based on a growing collection of [survey](#), [banding](#), and [citizen science datasets](#) and is returned to you as a list of those birds reported as occurring in the 10km grid cell(s) which your project intersects. Birds identified as warranting special attention because they are a BCC species in that area, an eagle (if requirements may apply), or a species that has a particular vulnerability to offshore activities or development. Again, the Migratory Bird Resource list includes only a subset of birds that may occur in your project area representative of all birds that may occur in your project area. To get a list of all birds potentially present in your area, please visit the [AKN Phenology Tool](#).

What does IPaC use to generate the probability of presence graphs for the migratory birds potentially occurring in my specified location?

The probability of presence graphs associated with your migratory bird list are based on data provided by the [Knowledge Network \(AKN\)](#). This data is derived from a growing collection of [survey](#), [banding](#), and [citizen science](#) data.

Probability of presence data is continuously being updated as new and better information becomes available. More about how the probability of presence graphs are produced and how to interpret them, go to the [Presence Summary](#) and then click on the "Tell me about these graphs" link.

How do I know if a bird is breeding, wintering, migrating or present year-round in my project area?

To see what part of a particular bird's range your project area falls within (i.e. breeding, wintering, migrating, or year-round), you may refer to the following resources: [The Cornell Lab of Ornithology All About Birds Bird Distribution](#) (unsuccessful in locating the bird of interest there), the [Cornell Lab of Ornithology Neotropical Birds Grid](#) (your migratory bird species list has a breeding season associated with it, if that bird does occur in your project area there may be nests present at some point within the timeframe specified. If "Breeds elsewhere" is indicated, the bird likely does not breed in your project area).

What are the levels of concern for migratory birds?

Migratory birds delivered through IPaC fall into the following distinct categories of concern:

1. "BCC Rangewide" birds are Birds of Conservation Concern (BCC) that are of concern throughout the United States anywhere within the USA (including Hawaii, the Pacific Islands, Puerto Rico, and the Virgin Islands).
2. "BCC - BCR" birds are BCCs that are of concern only in particular Bird Conservation Regions (BCRs), BCRs, and
3. "Non-BCC - Vulnerable" birds are not BCC species in your project area, but appear on your list either

Eagle Act requirements (for eagles) or (for non-eagles) potential susceptibilities in offshore areas for development or activities (e.g. offshore energy development or longline fishing).

Although it is important to try to avoid and minimize impacts to all birds, efforts should be made, in part, to minimize impacts to the birds on this list, especially eagles and BCC species of rangewide concern. Information on conservation measures you can implement to help avoid and minimize migratory bird requirements for eagles, please see the FAQs for these topics.

Details about birds that are potentially affected by offshore projects

For additional details about the relative occurrence and abundance of both individual bird species and species within your project area off the Atlantic Coast, please visit the [Northwest Ocean Data Portal](#). The data and information about other taxa besides birds that may be helpful to you in your project review may be downloaded from the bird model results files underlying the portal maps through the [NOAA NCCOS Integrated Modeling and Predictive Mapping of Marine Bird Distributions and Abundance on the Atlantic Outer Continental Shelf](#) project webpage.

Bird tracking data can also provide additional details about occurrence and habitat use throughout the migration. Models relying on survey data may not include this information. For additional information on tracking data, see the [Diving Bird Study](#) and the [nanotag studies](#) or contact [Caleb Spiegel](#) or [Pam Loritt](#).

What if I have eagles on my list?

If your project has the potential to disturb or kill eagles, you may need to [obtain a permit](#) to avoid violating the [Eagle Act](#) should such impacts occur.

Proper Interpretation and Use of Your Migratory Bird Report

The migratory bird list generated is not a list of all birds in your project area, only a subset of birds of concern. To learn more about how your list is generated, and see options for identifying what other birds may be present in your project area, please see the FAQ "What does IPaC use to generate the migratory birds potentially occurring in my project area?" Please be aware this report provides the "probability of presence" of birds within the 10 km grid cell(s).

Project footprint: not your exact project footprint. On the graphs provided, please also look carefully at the survey area by the black vertical bar) and for the existence of the "no data" indicator (a red horizontal bar). A high probability of presence score can be viewed as a key component. If the survey effort is high, then the probability of presence score can be viewed as a contrast, a low survey effort bar or no data bar means a lack of data and, therefore, a lack of certainty about the species. This list is not perfect: it is simply a starting point for identifying what birds of concern have in your project area, when they might be there, and if they might be breeding (which means nests in your project area). The list helps you know what to look for to confirm presence, and helps guide you in knowing when to take conservation measures to avoid or minimize potential impacts from your project activities, should presence be confirmed. To learn more about conservation measures, visit the FAQ "Tell me about conservation measures to avoid or minimize impacts to migratory birds" at the bottom of your migratory bird report.

Facilities

Wildlife refuges and fish hatcheries

REFUGE AND FISH HATCHERY INFORMATION IS NOT AVAILABLE AT THIS TIME

Wetlands in the National Wetlands Inventor

Impacts to NWI wetlands and other aquatic habitats may be subject to regulation under the Clean Water Act, or other State/Federal statutes.

For more information please contact the Regulatory Program of the local U.S. Army Corp District.

WETLAND INFORMATION IS NOT AVAILABLE AT THIS TIME

This can happen when the National Wetlands Inventory (NWI) map service is unavailable projects that intersect many wetland areas. Try again, or visit the NWI map to view wetland location.

Data limitations

The Service's objective of mapping wetlands and deepwater habitats is to produce reconnaissance level the location, type and size of these resources. The maps are prepared from the analysis of high altitude Wetlands are identified based on vegetation, visible hydrology and geography. A margin of error is in imagery; thus, detailed on-the-ground inspection of any particular site may result in revision of the wetland or classification established through image analysis.

The accuracy of image interpretation depends on the quality of the imagery, the experience of the imager, the amount and quality of the collateral data and the amount of ground truth verification work conducted. It may be consulted to determine the date of the source imagery used and any mapping problems.

Wetlands or other mapped features may have changed since the date of the imagery or field work. There may be occasional differences in polygon boundaries or classifications between the information depicted on the map and actual conditions on site.

Data exclusions

Certain wetland habitats are excluded from the National mapping program because of the limitations of the primary data source used to detect wetlands. These habitats include seagrasses or submerged aquatic vegetation that are found in the intertidal and subtidal zones of estuaries and nearshore coastal waters. Some of these communities (coral or tubercled worm reefs) have also been excluded from the inventory. These habitats may not be detected by aerial imagery.

Data precautions

Federal, state, and local regulatory agencies with jurisdiction over wetlands may define and describe wetlands in a different manner than that used in this inventory. There is no attempt, in either the design or production of the maps, to define the limits of proprietary jurisdiction of any Federal, state, or local government or to establish the scope of the regulatory programs of government agencies. Persons intending to engage in activities in wetlands should seek the advice of appropriate Federal, state, or local agencies concerning specified agency regulatory programs and proprietary jurisdictions that may affect such activities.

IPAC

U.S. Fish &

IPAC resource list

This report is an automatically generated list of species and other resources such as critical (collectively referred to as *trust resources*) under the U.S. Fish and Wildlife Service's (USFWS) that are known or expected to be on or near the project area referenced below. The list of trust resources that occur outside of the project area, but that could potentially be directly affected by activities in the project area. However, determining the likelihood and extent of project impacts may have on trust resources typically requires gathering additional site-specific (e.g., vegetation/species surveys) and project-specific (e.g., magnitude and timing of proposed activities) information.

Below is a summary of the project information you provided and contact information for the office(s) with jurisdiction in the defined project area. Please read the introduction to each section (Endangered Species, Migratory Birds, USFWS Facilities, and NWI Wetlands) for additional information applicable to the trust resources addressed in that section.

Location

Hamilton County, New York

Local office

New York Ecological Services Field Office

(607) 753-9334

(607) 753-9699

3817 Luker Road
Cortland, NY 13045-9385

<http://www.fws.gov/northeast/nyfo/es/section7.htm>

Endangered species

This resource list is for informational purposes only and does not constitute an analysis of potential impacts.

The primary information used to generate this list is the known or expected range of each species. Additional areas of influence (AOI) for species are also considered. An AOI includes areas upstream of a fish population, even if that fish does not occur at the dam site, may include areas by reducing or eliminating water flow downstream). Because species can move, conditions can change, the species on this list are not guaranteed to be found on or near the project area. To fully determine any potential effects to species, additional site-specific and project information is often required.

Section 7 of the Endangered Species Act requires Federal agencies to "request of the Secretary information whether any species which is listed or proposed to be listed may be present such proposed action" for any project that is conducted, permitted, funded, or licensed by the agency. A letter from the local office and a species list which fulfills this requirement can be requested from either the Regulatory Review section in IPAC (see below) or from the local field office directly.

For project evaluations that require USFWS concurrence/review, please return to the IPAC request an official species list by doing the following:

1. Draw the project location and click CONTINUE.
2. Click DEFINE PROJECT.
3. Log in (if directed to do so).
4. Provide a name and description for your project.
5. Click REQUEST SPECIES LIST.

Listed species¹ and their critical habitats are managed by the Ecological Services Program and Wildlife Service (USFWS) and the fisheries division of the National Oceanic and Atmospheric Administration (NOAA Fisheries²).

Species and critical habitats under the sole responsibility of NOAA Fisheries are not shown. Please contact [NOAA Fisheries](#) for species under their jurisdiction.

1. Species listed under the [Endangered Species Act](#) are threatened or endangered; I-Pac species that are candidates, or proposed, for listing. See the [listing status page](#) for more.
2. [NOAA Fisheries](#), also known as the National Marine Fisheries Service (NMFS), is an off National Oceanic and Atmospheric Administration within the Department of Commerce.

THERE ARE NO ENDANGERED SPECIES EXPECTED TO OCCUR AT THIS LOCATION.

Migratory birds

Certain birds are protected under the Migratory Bird Treaty Act¹ and the Bald and Golden Eagle Protection Act².

Any person or organization who plans or conducts activities that may result in impacts to eagles, and their habitats should follow appropriate regulations and consider implement conservation measures, as described [below](#).

1. The [Migratory Birds Treaty Act](#) of 1918.
2. The [Bald and Golden Eagle Protection Act](#) of 1940.

Additional information can be found using the following links:

- [Birds of Conservation Concern](http://www.fws.gov/birds/management/managed-species-of-conservation-concern.php) <http://www.fws.gov/birds/management/managed-species-of-conservation-concern.php>
- [Measures for avoiding and minimizing impacts to birds](http://www.fws.gov/birds/management/project-assessment-tools-and-guidance/conservation-measures.php) <http://www.fws.gov/birds/management/project-assessment-tools-and-guidance/conservation-measures.php>
- [Nationwide conservation measures for birds](http://www.fws.gov/migratorybirds/pdf/management/nationwidestandardconservation-measures.pdf) <http://www.fws.gov/migratorybirds/pdf/management/nationwidestandardconservation-measures.pdf>

The birds listed below are birds of particular concern either because they occur on the [U.S. Conservation Concern \(BCC\) list](#) or warrant special attention in your project location. To learn more about the levels of concern for birds on your list and how this list is generated, see the [FAQ](#) below. To learn more about the list of every bird you may find in this location, nor a guarantee that every bird on this list is a conservation concern. To see exact locations of where birders and the general public have sightings and around your project area, visit the [E-bird data mapping tool](#) (Tip: enter your location

range and a species on your list). For projects that occur off the Atlantic Coast, additional models detailing the relative occurrence and abundance of bird species on your list are available. Additional information about Atlantic Coast birds, and other important information about bird list, including how to properly interpret and use your migratory bird report, can be found in the [Migratory Bird Report User Guide](#). For guidance on when to schedule activities or implement avoidance and minimization to reduce impacts to migratory birds on your list, click on the [PROBABILITY OF PRESENCE SINCE 1900](#) tab at the top of your list to see when these birds are most likely to be present and breeding in your project area.

NAME

BREEDING SEASON
SEASON IS INDICATED
ON YOUR LIST, THROUGHOUT
BREED IN YOUR PROJECT
SOMETIME WITHIN
SPECIFIED, WHICH
LIBERAL ESTIMATE
INSIDE WHICH THE
ACROSS ITS ENTIRE
"BREEDS ELSEWHERE"

THAT THE BIRD DOES
BREED IN YOUR PROJECT

Breeds Dec 1 to

Bald Eagle *Haliaeetus leucocephalus*
This is not a Bird of Conservation Concern (BCC) in this area, but warrants attention because of the Eagle Act or for potential susceptibilities in offshore areas from certain types of development or activities.
<https://ecos.fws.gov/ecp/species/1626>

Bicknell's Thrush *Catharus bicknelli*

This is a Bird of Conservation Concern (BCC) throughout its range in the continental USA and Alaska.
<https://ecos.fws.gov/ecp/species/606>

Breeds Jun 10 to

Canada Warbler *Cardellina canadensis*

This is a Bird of Conservation Concern (BCC) throughout its range in the continental USA and Alaska.

Breeds May 20 to

Cape May Warbler *Setophaga tigrina*

This is a Bird of Conservation Concern (BCC) throughout its range in the continental USA and Alaska.

Breeds Jun 1 to

Wood Thrush *Hylocichla mustelina* Breeds May 10
 This is a Bird of Conservation Concern (BCC) throughout its range in the continental USA and Alaska.

Probability of Presence Summary

The graphs below provide our best understanding of when birds of concern are most likely in your project area. This information can be used to tailor and schedule your project act minimize impacts to birds. Please make sure you read and understand the FAQ "Proper Use and Use of Your Migratory Bird Report" before using or attempting to interpret this report.

Probability of Presence (■)

Each green bar represents the bird's relative probability of presence in the 10km grid cell overlaps during a particular week of the year. (A year is represented as 12 4-week months indicates a higher probability of species presence. The survey effort (see below) can be used to indicate a level of confidence in the presence score. One can have higher confidence in the presence corresponding survey effort is also high.

How is the probability of presence score calculated? The calculation is done in three steps

1. The probability of presence for each week is calculated as the number of survey events where the species was detected divided by the total number of survey events for that example, if in week 12 there were 20 survey events and the Spotted Towhee was four the probability of presence of the Spotted Towhee in week 12 is 0.25.

2. To properly present the pattern of presence across the year, the relative probability is calculated. This is the probability of presence divided by the maximum probability of all weeks. For example, imagine the probability of presence in week 20 for the Spotted Towhee and that the probability of presence at week 12 (0.25) is the maximum of any week of relative probability of presence on week 12 is $0.25/0.25 = 1$; at week 20 it is $0.05/0.25 = 0.2$.
3. The relative probability of presence calculated in the previous step undergoes a statistical test so that all possible values fall between 0 and 10, inclusive. This is the probability of presence so that all possible values fall between 0 and 10, inclusive. This is the probability of presence score, simply hover your mouse cursor over the bar.

Breeding Season (|)

Yellow bars denote a very liberal estimate of the time-frame inside which the bird breeds; range. If there are no yellow bars shown for a bird, it does not breed in your project area.

Survey Effort (|)

Vertical black lines superimposed on probability of presence bars indicate the number of

performed for that species in the 10km grid cell(s) your project area overlaps. The number expressed as a range, for example, 33 to 64 surveys.

To see a bar's survey effort range, simply hover your mouse cursor over the bar.

No Data (-)

A week is marked as having no data if there were no survey events for that week.

Survey Timeframe

Surveys from only the last 10 years are used in order to ensure delivery of currently relevant data. The exception to this is areas off the Atlantic coast, where bird returns are based on all available data, since data in these areas is currently much more sparse.



Conservation Concern (BCC) throughout its range in the continental USA and Alaska)

Wood Thrush
BCC Rangelwide (CON)
(This is a Bird of Conservation Concern (BCC) throughout its range in the continental USA and Alaska.)

Tell me more about conservation measures I can implement to avoid or minimize impacts to migratory birds?

Nationwide Conservation Measures describes measures that can help avoid and minimize impacts to location year round. Implementation of these measures is particularly important when birds are most the project area. When birds may be breeding in the area, identifying the locations of any active nests destruction is a very helpful impact minimization measure. To see when birds are most likely to occur your project area, view the [Probability of Presence Summary](#). Additional measures and/or permits may depending on the type of activity you are conducting and the type of infrastructure or bird species pre project site.

What does IPAC use to generate the migratory birds potentially occurring in my specified location?

The [Migratory Bird Resource List](#) is comprised of USFWS [Birds of Conservation Concern \(BCC\)](#) and other warrant special attention in your project location.

The [migratory bird list](#) generated for your project is derived from data provided by the [Avian Knowledge Network \(AKN\)](#). The AKN data is based on a growing collection of survey, banding, and citizen science datasets and is used to return a list of those birds reported as occurring in the 10km grid cell(s) which your project intersects. Birds identified as warranting special attention because they are a BCC species in that area, an eagle (if requirements may apply), or a species that has a particular vulnerability to offshore activities or development. Again, the [Migratory Bird Resource list](#) includes only a subset of birds that may occur in your project area representative of all birds that may occur in your project area. To get a list of all birds potentially present in your area, please visit the [AKN Phenology Tool](#).

What does IPAC use to generate the probability of presence graphs for the migratory birds potentially occurring in my specified location?

The probability of presence graphs associated with your migratory bird list are based on data provided by the [Knowledge Network \(AKN\)](#). This data is derived from a growing collection of [survey, banding, and citizen science](#) data.

Probability of presence data is continuously being updated as new and better information becomes available. For more information, please visit the [AKN Phenology Tool](#).

How do I know if a bird is breeding, wintering, migrating or present year-round in my project area?

To see what part of a particular bird's range your project area falls within (i.e. breeding, wintering, migrating, or present year-round), you may refer to the following resources: [The Cornell Lab of Ornithology All About Birds Bird Range Finder](#) (unsuccessful in locating the bird of interest there), the [Cornell Lab of Ornithology Neotropical Birds Geographic Range Finder](#) (your migratory bird species list has a breeding season associated with it, if that bird does occur in your project area, there may be nests present at some point within the timeframe specified. If "Breeds elsewhere" is indicated, the bird likely does not breed in your project area).

What are the levels of concern for migratory birds?

Migratory birds delivered through IPAC fall into the following distinct categories of concern:

1. "BCC Rangelwide" birds are [Birds of Conservation Concern \(BCC\)](#) that are of concern throughout the United States within the USA (including Hawaii, the Pacific Islands, Puerto Rico, and the Virgin Islands)
2. "BCC - BCR" birds are BCCs that are of concern only in particular Bird Conservation Regions (BCRs) within the USA; and
3. "Non-BCC - Vulnerable" birds are not BCC species in your project area, but appear on your list with [Eagle Act](#) requirements (for eagles) or (for non-eagles) potential susceptibilities in offshore areas of development or activities (e.g. offshore energy development or longline fishing).

Although it is important to try to avoid and minimize impacts to all birds, efforts should be made, in part, to avoid and minimize impacts to the birds on this list, especially eagles and BCC species of rangelwide concern. For more information on conservation measures you can implement to help avoid and minimize migratory bird impacts, please see the [FAQs](#) for these topics.

Details about birds that are potentially affected by offshore projects

For additional details about the relative occurrence and abundance of both individual bird species and species within your project area off the Atlantic Coast, please visit the [Northwest Ocean Data Portal](#). This data and information about other taxa besides birds that may be helpful to you in your project review may be downloaded from the [NOAA NCCOS Data Portal](#). For more information on the [NOAA NCCOS Data Portal](#), please visit the [NOAA NCCOS Data Portal](#) website.

Bird tracking data can also provide additional details about occurrence and habitat use throughout the project area. Models relying on survey data may not include this information. For additional information on tracking data, see the [Diving Bird Study](#) and the [Nanotag studies](#) or contact [Caleb Spiegel](#) or [Pam Loftr](#).

What if I have eagles on my list?

If your project has the potential to disturb or kill eagles, you may need to obtain a permit to avoid violating the [Eagle Act](#).

Proper Interpretation and Use of Your Migratory Bird Report

For more information, please visit the [AKN Phenology Tool](#).

The migratory bird list generated is not a list of all birds in your project area, only a subset of birds of interest. To learn more about how your list is generated, and see options for identifying what other birds may be included, please see the FAQ "What does IPAC use to generate the migratory birds potentially occurring in my study area?" Please be aware this report provides the "probability of presence" of birds within the 10 km grid cells:

project; not your exact project footprint. On the graphs provided, please also look carefully at the sun by the black vertical bar) and for the existence of the "no data" indicator (a red horizontal bar). A high key component. If the survey effort is high, then the probability of presence score can be viewed as much higher. In contrast, a low survey effort bar or no data bar means a lack of data and, therefore, a lack of certainty about the species. This list is not perfect; it is simply a starting point for identifying what birds of concern have been in your project area, when they might be there, and if they might be breeding (which means nests). The list helps you know what to look for to confirm presence, and helps guide you in knowing when to take conservation measures to avoid or minimize potential impacts from your project activities, should they be confirmed. To learn more about conservation measures, visit the FAQ "Tell me about conservation measures to avoid or minimize impacts to migratory birds" at the bottom of your migratory bird trust report.

Facilities

National Wildlife Refuge lands

Any activity proposed on lands managed by the [National Wildlife Refuge](#) system must undergo a 'Compatibility Determination' conducted by the Refuge. Please contact the individual Refuge for any questions or concerns.

THERE ARE NO REFUGE LANDS AT THIS LOCATION.

Fish hatcheries

THERE ARE NO FISH HATCHERIES AT THIS LOCATION.

Wetlands in the National Wetlands Inventory

Impacts to [NWI wetlands](#) and other aquatic habitats may be subject to regulation under the Clean Water Act, or other State/Federal statutes.

FOR MORE INFORMATION, PLEASE CONTACT THE DISTRICT ENGINEER AT 1-800-451-1111 OR [www.fws.gov](#)

FOR MORE INFORMATION, PLEASE CONTACT THE DISTRICT ENGINEER AT 1-800-451-1111 OR [www.fws.gov](#)

THERE ARE NO KNOWN WETLANDS AT THIS LOCATION.

Data limitations

The Service's objective of mapping wetlands and deepwater habitats is to produce reconnaissance level maps of the location, type and size of these resources. The maps are prepared from the analysis of high altitude aerial photography. Wetlands are identified based on vegetation, visible hydrology and geography. A margin of error is inherent in this process.

imagery; thus, detailed on-the-ground inspection of any particular site may result in revision of the wetland classification established through image analysis.

The accuracy of image interpretation depends on the quality of the imagery, the experience of the interpreter, the amount and quality of the collateral data and the amount of ground truth verification work conducted. The maps are prepared from the analysis of high altitude aerial photography. Wetlands are identified based on vegetation, visible hydrology and geography. A margin of error is inherent in this process.

Wetlands or other mapped features may have changed since the date of the imagery or field work. The maps are prepared from the analysis of high altitude aerial photography. Wetlands are identified based on vegetation, visible hydrology and geography. A margin of error is inherent in this process.

Data exclusions

Certain wetland habitats are excluded from the National Wetlands Inventory because of the limitations of the primary data source used to detect wetlands. These habitats include seagrasses or submerged aquatic vegetation that are found in the intertidal and subtidal zones of estuaries and nearshore coastal waters. Some of these communities (coral or tubercled worm reefs) have also been excluded from the inventory. These habitats are excluded from the inventory.

Data precautions

Federal, state, and local regulatory agencies with jurisdiction over wetlands may define and describe wetlands in a different manner than that used in this inventory. There is no attempt, in either the design or product development, to define the limits of proprietary jurisdiction of any Federal, state, or local government or to establish the scope of the regulatory programs of government agencies. Persons intending to engage in activities in wetlands or adjacent to wetland areas should seek the advice of appropriate federal, state, or local regulatory agencies concerning specified agency regulatory programs and proprietary jurisdictions that may affect such activities.

IPac

U.S. Fish &

IPac resource list

This report is an automatically generated list of species and other resources such as critical (collectively referred to as *trust resources*) under the U.S. Fish and Wildlife Service's (USFWS) that are known or expected to be on or near the project area referenced below. The list includes trust resources that occur outside of the project area, but that could potentially be directly affected by activities in the project area. However, determining the likelihood and extent of project impacts may have on trust resources typically requires gathering additional site-specific (e.g., vegetation/species surveys) and project-specific (e.g., magnitude and timing of proposed activities) information.

Below is a summary of the project information you provided and contact information for the office(s) with jurisdiction in the defined project area. Please read the introduction to each section (Endangered Species, Migratory Birds, USFWS Facilities, and NWI Wetlands) for additional information applicable to the trust resources addressed in that section.

Location

Hamilton County, New York

Local office

New York Ecological Services Field Office

☎ (607) 753-9334

📠 (607) 753-9699

3817 Luker Road

Cortland, NY 13045-9385

<http://www.fws.gov/northeast/nyfo/es/section7.htm>

Endangered species

This resource list is for informational purposes only and does not constitute an analytical level impacts.

The primary information used to generate this list is the known or expected range of each species. Additional areas of influence (AOI) for species are also considered. An AOI includes areas where a species range if the species could be indirectly affected by activities in that area (e.g., plan upstream of a fish population, even if that fish does not occur at the dam site, may indirectly be affected by reducing or eliminating water flow downstream). Because species can move, and conditions can change, the species on this list are not guaranteed to be found on or near the project area. To fully determine any potential effects to species, additional site-specific and project information is often required.

Section 7 of the Endangered Species Act requires Federal agencies to "request of the Sec

information whether any species which is listed or proposed to be listed may be present such proposed action" for any project that is conducted, permitted, funded, or licensed by the agency. A letter from the local office and a species list which fulfills this requirement can be requested by requesting an official species list from either the Regulatory Review section in IPAC (see below) or from the local field office directly.

For project evaluations that require USFWS concurrence/review, please return to the IPAC request an official species list by doing the following:

1. Draw the project location and click CONTINUE.
2. Click DEFINE PROJECT.
3. Log in (if directed to do so).
4. Provide a name and description for your project.
5. Click REQUEST SPECIES LIST.

Listed species¹ and their critical habitats are managed by the Ecological Services Program and Wildlife Service (USFWS) and the fisheries division of the National Oceanic and Atmospheric Administration (NOAA Fisheries²).

Species and critical habitats under the sole responsibility of NOAA Fisheries are not shown. Please contact NOAA Fisheries for species under their jurisdiction.

1. Species listed under the Endangered Species Act are threatened or endangered; IPAC species that are candidates, or proposed, for listing. See the listing status page for more information.
2. NOAA Fisheries, also known as the National Marine Fisheries Service (NMFS), is an off National Oceanic and Atmospheric Administration within the Department of Commerce.

THERE ARE NO ENDANGERED SPECIES EXPECTED TO OCCUR AT THIS LOCATION.

Migratory birds

Certain birds are protected under the Migratory Bird Treaty Act¹ and the Bald and Golden Eagle Protection Act².

Any person or organization who plans or conducts activities that may result in impacts to eagles, and their habitats should follow appropriate regulations and consider implementing conservation measures, as described below.

1. The Migratory Birds Treaty Act of 1918.

2. The Bald and Golden Eagle Protection Act of 1940.

Additional information can be found using the following links:

- Birds of Conservation Concern <http://www.fws.gov/birds/management/managed-species-of-concern-concern.php>
- Measures for avoiding and minimizing impacts to birds <http://www.fws.gov/birds/management/project-assessment-tools-and-guidance/conservation-measures.php>
- Nationwide conservation measures for birds <http://www.fws.gov/migratorybirds/pdf/management/nationwidestandardconservation-measures.pdf>

The birds listed below are birds of particular concern either because they occur on the U.S. Conservation Concern (BCC) list or warrant special attention in your project location. To list the levels of concern for birds on your list and how this list is generated, see the FAQ below. For every bird you may find in this location, nor a guarantee that every bird on this list is your project area. To see exact locations of where birds and the general public have sightings and around your project area, visit the E-bird data mapping tool (Tip: enter your location range and a species on your list). For projects that occur off the Atlantic Coast, additional models detailing the relative occurrence and abundance of bird species on your list are available. Additional information about Atlantic Coast birds, and other important information about bird list, including how to properly interpret and use your migratory bird report, can be found here.

For guidance on when to schedule activities or implement avoidance and minimization to reduce impacts to migratory birds on your list, click on the PROBABILITY OF PRESENCE section at the top of your list to see when these birds are most likely to be present and breeding in your project area.

NAME

BREEDING SEASON
SEASON IS INDICATED
ON YOUR LIST. THE
BREED IN YOUR PROJECT
SOMETIME WITHIN
SPECIFIED, WHICH
LIBERAL ESTIMATE
INSIDE WHICH THE
ACROSS ITS ENTIRE
"BREEDS ELSEWHERE"

THAT THE BIRD DOES
BREED IN YOUR PROJECT

Breeds Dec 1 to

Bald Eagle Haliaeetus leucocephalus

This is not a Bird of Conservation Concern (BCC) in this area, but warrants attention because of the Eagle Act or for potential susceptibilities in offshore areas from certain types of development or activities.

<https://ecos.fws.gov/ecp/species/1626>

Bicknell's Thrush *Catharus bicknelli*

Breeds Jun 10 to

This is a Bird of Conservation Concern (BCC) throughout its range in the continental USA and Alaska.

<https://ecos.fws.gov/ecp/species/606>

Canada Warbler *Cardellina canadensis*

Breeds May 20 to

This is a Bird of Conservation Concern (BCC) throughout its range in the continental USA and Alaska.

Cape May Warbler *Setophaga tigrina*

Breeds Jun 1 to

This is a Bird of Conservation Concern (BCC) throughout its range in the continental USA and Alaska.

Wood Thrush *Hylocichla mustelina*

Breeds May 10 to

This is a Bird of Conservation Concern (BCC) throughout its range in the continental USA and Alaska.

Probability of Presence Summary

The graphs below provide our best understanding of when birds of concern are most likely in your project area. This information can be used to tailor and schedule your project act minimize impacts to birds. Please make sure you read and understand the FAQ "Proper Use and Use of Your Migratory Bird Report" before using or attempting to interpret this report.

Probability of Presence (■)

Each green bar represents the bird's relative probability of presence in the 10km grid cell overlaps during a particular week of the year. (A year is represented as 12 4-week month intervals indicating a higher probability of species presence. The survey effort (see below) can be used to indicate a level of confidence in the presence score. One can have higher confidence in the presence corresponding survey effort is also high.

How is the probability of presence score calculated? The calculation is done in three steps:

1. The probability of presence for each week is calculated as the number of survey events where the species was detected divided by the total number of survey events for that week. For example, if in week 12 there were 20 survey events and the Spotted Towhee was found in 4 of those events, the probability of presence of the Spotted Towhee in week 12 is 0.25.

2. To properly present the pattern of presence across the year, the relative probability of presence is calculated. This is the probability of presence divided by the maximum probability of presence for all weeks. For example, imagine the probability of presence in week 20 for the Spotted Towhee and that the probability of presence at week 12 (0.25) is the maximum of any week of relative probability of presence on week 12 is $0.25/0.25 = 1$; at week 20 it is $0.05/0.25 = 0.2$.
3. The relative probability of presence calculated in the previous step undergoes a statistical test so that all possible values fall between 0 and 1, inclusive. This is the probability of presence.

To see a bar's probability of presence score, simply hover your mouse cursor over the bar.

Breeding Season ()

Yellow bars denote a very liberal estimate of the time-frame inside which the bird breeds. If there are no yellow bars shown for a bird, it does not breed in your project area.

Survey Effort (|)

Vertical black lines superimposed on probability of presence bars indicate the number of surveys performed for that species in the 10km grid cell(s) your project area overlaps. The number is expressed as a range, for example, 33 to 64 surveys.

To see a bar's survey effort range, simply hover your mouse cursor over the bar.

No Data (-)

A week is marked as having no data if there were no survey events for that week.

Survey Timeframe

Surveys from only the last 10 years are used in order to ensure delivery of currently relevant data. The exception to this is areas off the Atlantic coast, where bird returns are based on all available data, since data in these areas is currently much more sparse.



BCC Rangewide (CON)
(This is a Bird of Conservation Concern (BCC) throughout its range in the continental USA and Alaska.)

Canada Warbler
BCC Rangewide (CON)
(This is a Bird of Conservation Concern (BCC) throughout its range in the continental USA and Alaska.)

Cape May Warbler
BCC Rangewide (CON)
(This is a Bird of Conservation Concern (BCC) throughout its range in the continental USA and Alaska.)

Wood Thrush
BCC Rangewide (CON)
(This is a Bird of Conservation Concern (BCC) throughout its range in the continental USA and Alaska.)

Tell me more about conservation measures I can implement to avoid or minimize impacts to migratory birds.
Nationwide Conservation Measures describes measures that can help avoid and minimize impacts to migratory birds. Implementation of these measures is particularly important when birds are most abundant in the project area. When birds may be breeding in the area, identifying the locations of any active nests and avoiding them is a very helpful impact minimization measure. To see when birds are most likely to occur in your project area, view the [Probability of Presence Summary](#). [Additional measures](#) and/or [permits](#) may be required depending on the type of activity you are conducting and the type of infrastructure or bird species present at your project site.

What does IPAC use to generate the migratory birds potentially occurring in my specified location?

The Migratory Bird Resource List is comprised of USFWS [Birds of Conservation Concern \(BCC\)](#) and other species of concern in your project location.

The migratory bird list generated for your project is derived from data provided by the [Avian Knowledge Network \(AKN\)](#). The AKN data is based on a growing collection of survival, banding, and citizen science datasets and is

to return a list of those birds reported as occurring in the 10km grid cell(s) which your project interest has been identified as warranting special attention because they are a BCC species in that area, an eagle (requirements may apply), or a species that has a particular vulnerability to offshore activities or development. Again, the Migratory Bird Resource List includes only a subset of birds that may occur in your project area. A representative list of all birds that may occur in your project area. To get a list of all birds potentially present in your project area, please visit the [AKN Phenology Tool](#).

What does IPAC use to generate the probability of presence graphs for the migratory birds potentially occurring in my specified location?

The probability of presence graphs associated with your migratory bird list are based on data provided by the [Knowledge Network \(AKN\)](#). This data is derived from a growing collection of [survey](#), [banding](#), and [citizen science](#) data.

Probability of presence data is continuously being updated as new and better information becomes available. More about how the probability of presence graphs are produced and how to interpret them, go to the [Probability of Presence Summary](#) and then click on the "Tell me about these graphs" link.

How do I know if a bird is breeding, wintering, migrating or present year-round in my project area?

To see what part of a particular bird's range your project area falls within (i.e. breeding, wintering, migrating, or present year-round), you may refer to the following resources: [The Cornell Lab of Ornithology All About Birds Bird Distribution](#) (unsuccessful in locating the bird of interest there), the [Cornell Lab of Ornithology Neotropical Birds Geographic Distribution](#) (your migratory bird species list has a breeding season associated with it, if that bird does occur in your project area there may be nests present at some point within the timeframe specified. If "Breeds elsewhere" is indicated, the bird likely does not breed in your project area).

What are the levels of concern for migratory birds?

Migratory birds delivered through IPAC fall into the following distinct categories of concern:

1. "BCC Rangewide" birds are Birds of Conservation Concern (BCC) that are of concern throughout the United States within the USA (including Hawaii, the Pacific Islands, Puerto Rico, and the Virgin Islands).
2. "BCC - BCR" birds are BCCs that are of concern only in particular Bird Conservation Regions (BCRs), States, and
3. "Non-BCC - Vulnerable" birds are not BCC species in your project area, but appear on your list with [Eagle Act](#) requirements (for eagles) or (for non-eagles) potential susceptibilities in offshore areas for development or activities (e.g. offshore energy development or longline fishing).

Although it is important to try to avoid and minimize impacts to all birds, efforts should be made, in part, to avoid and minimize impacts to the birds on this list, especially eagles and BCC species of rangewide concern. Information on conservation measures you can implement to help avoid and minimize migratory bird requirements for eagles, please see the [FAQs](#) for these topics.

Details about birds that are potentially affected by offshore projects

For additional details about the relative occurrence and abundance of both individual bird species and species within your project area off the Atlantic Coast, please visit the [Northeast Ocean Data Portal](#). The data and information about other taxa besides birds that may be helpful to you in your project review may download the bird model results files underlying the portal maps through the [NOAA NCCOS Inter Modeling and Predictive Mapping of Marine Bird Distributions and Abundance on the Atlantic Outer Continental Shelf](#) project webpage.

Bird tracking data can also provide additional details about occurrence and habitat use throughout the migration. Models relying on survey data may not include this information. For additional information tracking data, see the [Diving Bird Study](#) and the [nanotag studies](#) or contact [Caleb Spiegel](#) or [Pam Loritt](#)

What if I have eagles on my list?

If your project has the potential to disturb or kill eagles, you may need to [obtain a permit](#) to avoid violations should such impacts occur.

Proper Interpretation and Use of Your Migratory Bird Report

The migratory bird list generated is not a list of all birds in your project area, only a subset of birds of which you learn more about how your list is generated, and see options for identifying what other birds may be included. Please see the FAQ "What does IPAC use to generate the migratory birds potentially occurring in my site?" Please be aware this report provides the "probability of presence" of birds within the 10 km grid cells.

project; not your exact project footprint. On the graphs provided, please also look carefully at the sun by the black vertical bar) and for the existence of the "no data" indicator (a red horizontal bar). A high key component: if the survey effort is high, then the probability of presence score can be viewed as much lower; contrast, a low survey effort bar or no data bar means a lack of data and, therefore, a lack of certainty about the species. This list is not perfect; it is simply a starting point for identifying what birds of concern have in your project area, when they might be there, and if they might be breeding (which means nests). The list helps you know what to look for to confirm presence, and helps guide you in knowing when to take conservation measures to avoid or minimize potential impacts from your project activities, should they be confirmed. To learn more about conservation measures, visit the FAQ "Tell me about conservation measures to avoid or minimize impacts to migratory birds" at the bottom of your migratory bird trust

Facilities

National Wildlife Refuge lands

Any activity proposed on lands managed by the [National Wildlife Refuge](#) system must undergo a 'Compatibility Determination' conducted by the Refuge. Please contact the individual Refuge

any questions or concerns.

THERE ARE NO REFUGES AT THIS LOCATION.

Fish hatcheries

THERE ARE NO FISH HATCHERIES AT THIS LOCATION.

Wetlands in the National Wetlands Inventory

Impacts to [NWI wetlands](#) and other aquatic habitats may be subject to regulation under the Clean Water Act, or other State/Federal statutes.

For more information please contact the Regulatory Program of the local [U.S. Army Corps of Engineers](#) District.

THERE ARE NO KNOWN WETLANDS AT THIS LOCATION.

Data limitations

The Service's objective of mapping wetlands and deepwater habitats is to produce reconnaissance level maps of the location, type and size of these resources. The maps are prepared from the analysis of high altitude aerial photography and other data sources. Wetlands are identified based on vegetation, visible hydrology and geography. A margin of error is inherent in the mapping process.

Imagery: thus, detailed on-the-ground inspection of any particular site may result in revision of the wetland classification established through image analysis.

The accuracy of image interpretation depends on the quality of the imagery, the experience of the interpreter, the amount and quality of the collateral data and the amount of ground truth verification work conducted. The accuracy of the data used to determine the date of the source imagery used and any mapping problems.

Wetlands or other mapped features may have changed since the date of the imagery or field work. The occasional differences in polygon boundaries or classifications between the information depicted on the map and the actual conditions on site.

Data exclusions

Certain wetland habitats are excluded from the National Wetlands Inventory because of the limitations of the data source used to detect wetlands. These habitats include seagrasses or submerged aquatic vegetation.

that are found in the intertidal and subtidal zones of estuaries and nearshore coastal waters. Some of communities (coral or tubercificid worm reefs) have also been excluded from the inventory. These habitats, go undetected by aerial imagery.

Data precautions

Federal, state, and local regulatory agencies with jurisdiction over wetlands may define and describe in a different manner than that used in this inventory. There is no attempt, in either the design or product to define the limits of proprietary jurisdiction of any Federal, state, or local government or to establish the scope of the regulatory programs of government agencies. Persons intending to engage in activities or modifications within or adjacent to wetland areas should seek the advice of appropriate federal, state or local regulatory agencies concerning specified agency regulatory programs and proprietary jurisdictions that may affect such activities.

ATTACHMEN
SHPO Consultation Lei

ATTACHMEN
Proposed Sign Des



Proposed Sign: Front side

Post Height = 12'10" per existing

BML = 4.5' x 5'

Home of = 4.5 x 1'

Materials – painted wood or 16gg aluminum with matte over laminate

Pressure treated Posts = 6" x 6"

Type size =

BLUE – approx. 1'

Mountain Lake – approx. 6"

Home of... Arts Center – approx. 2" high

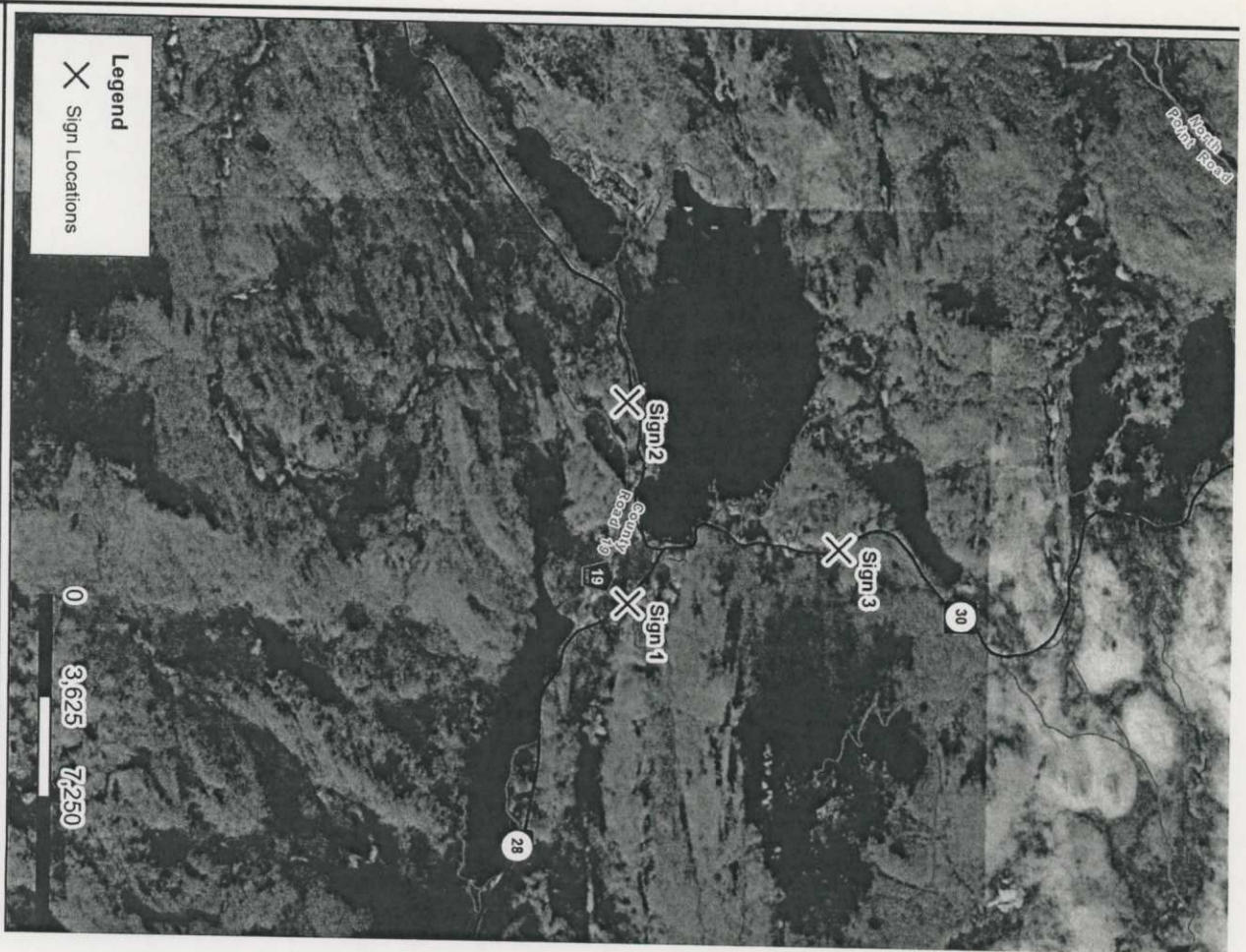

THE
Chazen
CONSULTANTS

Dunkirk County Office:
21 East Street, Dunkirk, NY 13601
Phone: (815) 454-3300

Capital District Office:
57 Water Street, Troy, NY 12180

**Blue Mountain Lake Signage
Site Location Map**

COMPANIES Phone: (315) 273-0035

INCORPORATED IN NEW YORK STATE
LANDSCAPE ARCHITECTS
REGISTERED PROFESSIONALS
20 Elm Street, Great Falls, NY 13601
Phone: (315) 812-0113

Rt. 30 and Rt. 28
Town of Indian Lake - Hamilton County, New York

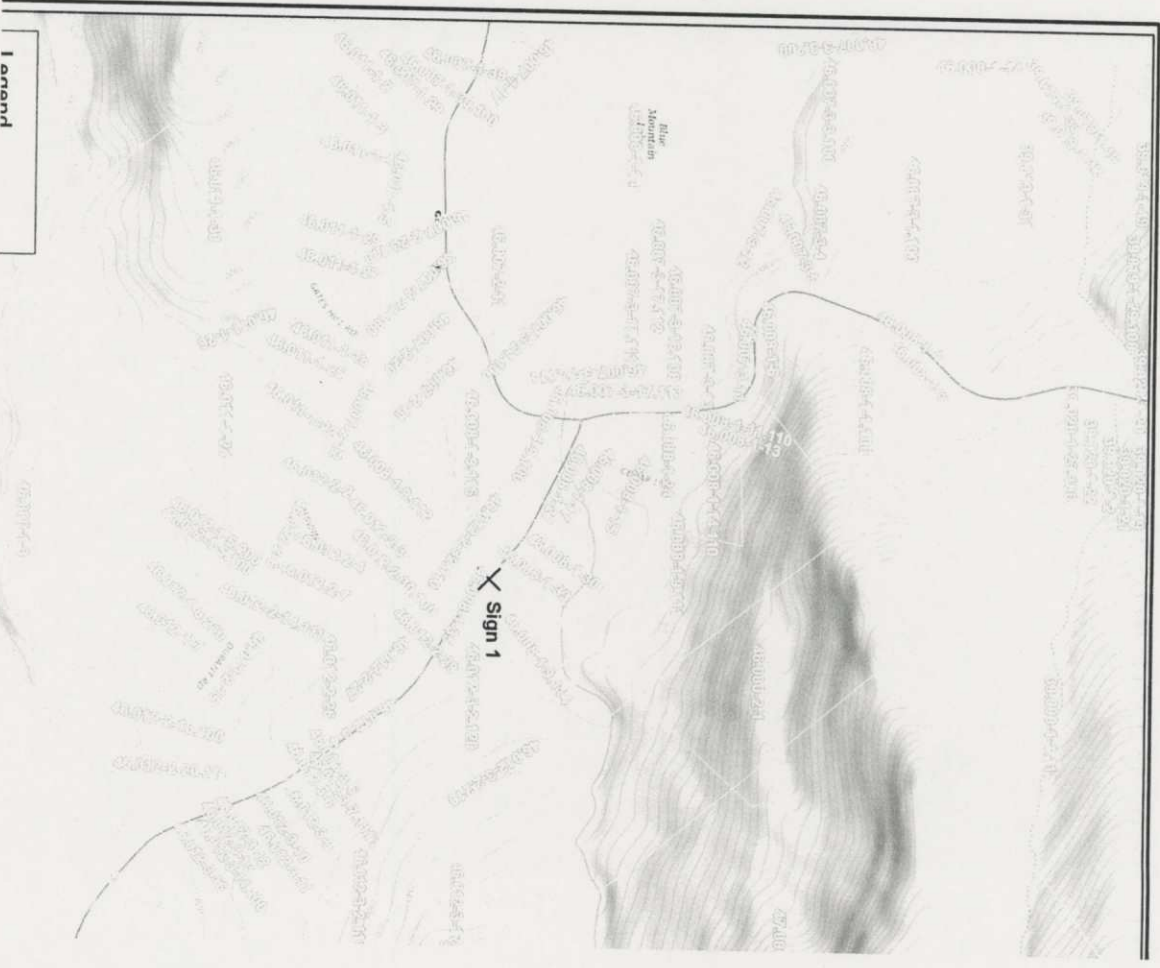

1 inamd

Legend
X Sign Locations

0 700 1,400

THE Chasem COMPANIES
INCORPORATED
LAND SURVEYING
ENGINEERING
ARCHITECTURE
PLANNING
DESIGN
CONSULTANTS

Dutchess County Office:
21 Fox Street, Poughkeepsie, NY 12601
Phone: (845) 454-3980

Capital District Office:
547 River Street, Troy, NY 12180
Phone: (518) 273-0055

North Country Office:
100 Exchange Street, Plattsburgh, NY 12601
Phone: (518) 812-0513

Blue Mountain Lake Signage

Sign 1 - Location Map

Rt. 30 and Rt. 28
Town of Indian Lake - Hamilton County, New York

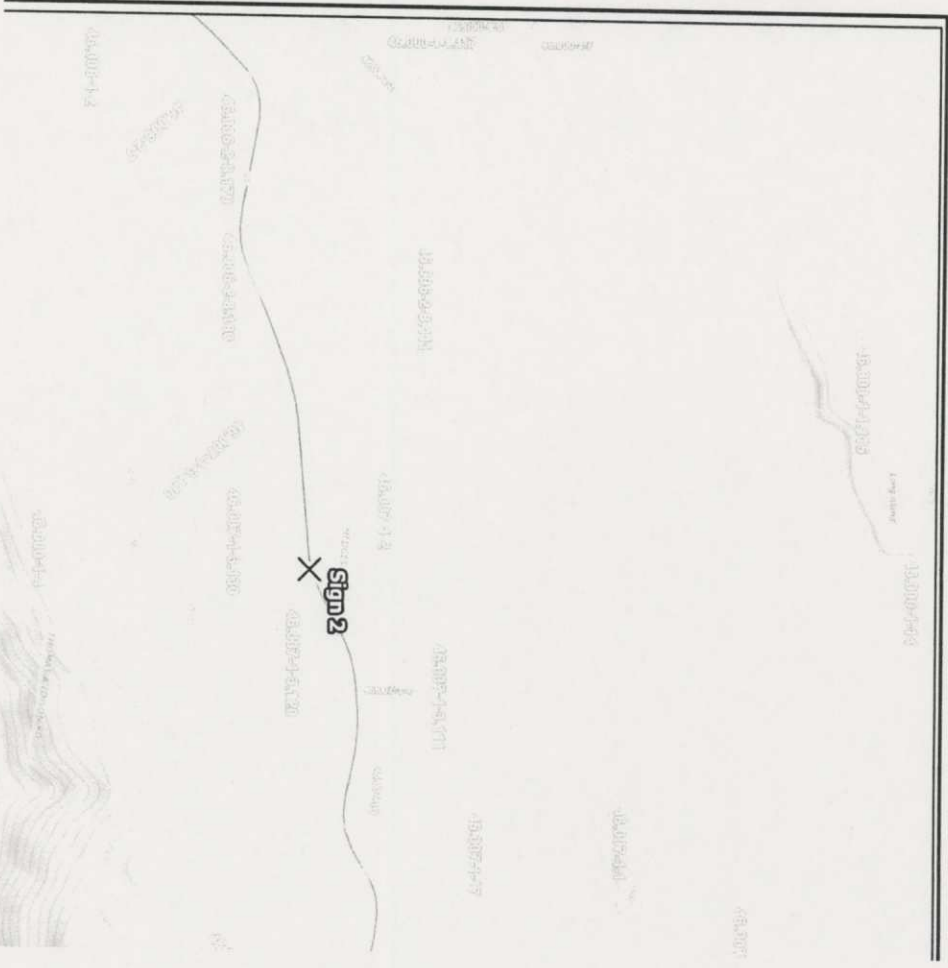

Legend
X Sign Location
Tax Parcels

0 700 1,400

THE Chasem COMPANIES
INCORPORATED
LAND SURVEYING
ENGINEERING
ARCHITECTURE
PLANNING
DESIGN
CONSULTANTS

Dutchess County Office:
21 Fox Street, Poughkeepsie, NY 12601
Phone: (845) 454-3980

Capital District Office:
547 River Street, Troy, NY 12180
Phone: (518) 273-0055

North Country Office:
100 Exchange Street, Plattsburgh, NY 12601
Phone: (518) 812-0513

Blue Mountain Lake Signage

Sign 2 - Location Map

Rt. 28N and Rt. 30
Town of Indian Lake - Hamilton County, New York

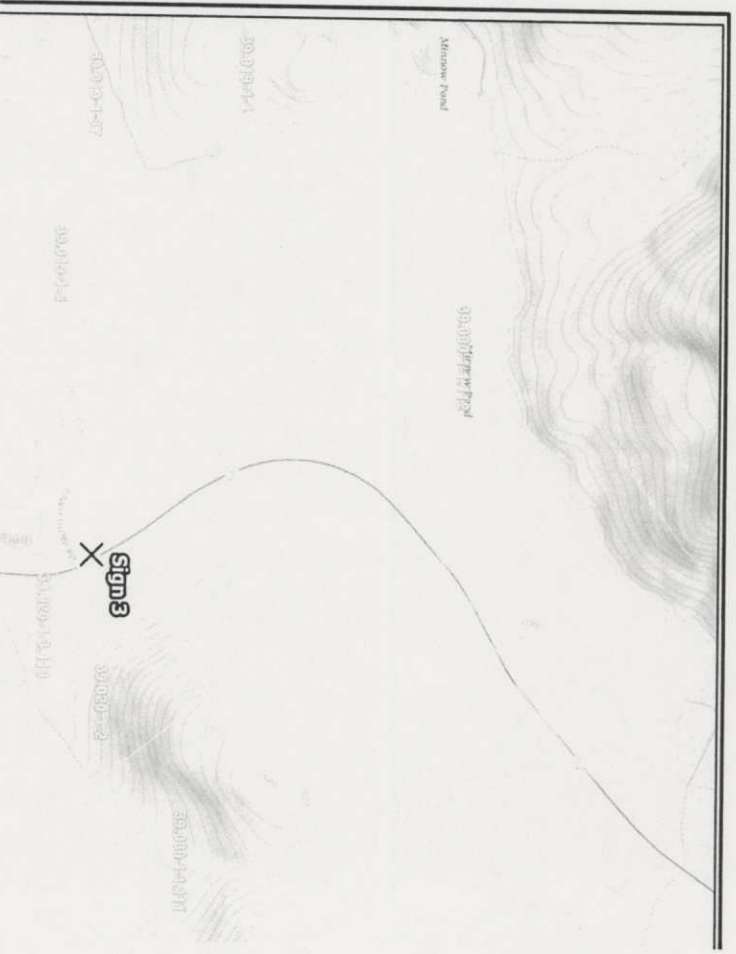

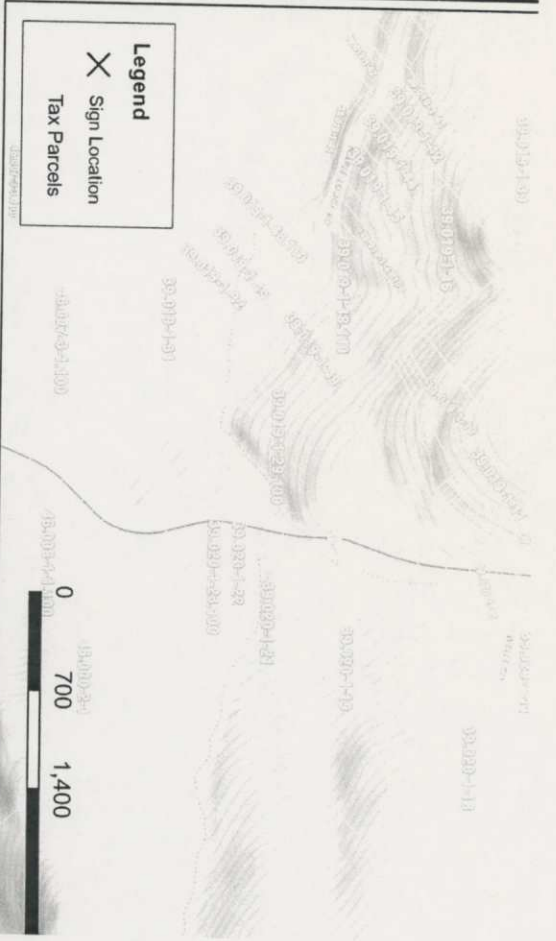

THE Chaspen COMPANIES
 LAND DEVELOPMENT AND SITE PREPARATION SERVICES
 INCORPORATED IN NEW YORK STATE
 1400 WESTCHESTER AVENUE, SUITE 200
 WESTCHESTER, NEW YORK 12591-2000
 Phone: (518) 312-0113

Dutchess County Office:
 21 Fox Street, Poughkeepsie, NY 12601
 Phone: (845) 454-3980

Capital District Office:
 547 River Street, Troy, NY 12180
 Phone: (518) 273-0055

North County Office:
 20 Elm Street, Otisville, NY 12851
 Phone: (518) 312-0113

Blue Mountain Lake Signage
Sign 3 - Location Map
 RI, 28N and RI, 30
 Town of Indian Lake - Hamilton County, New York

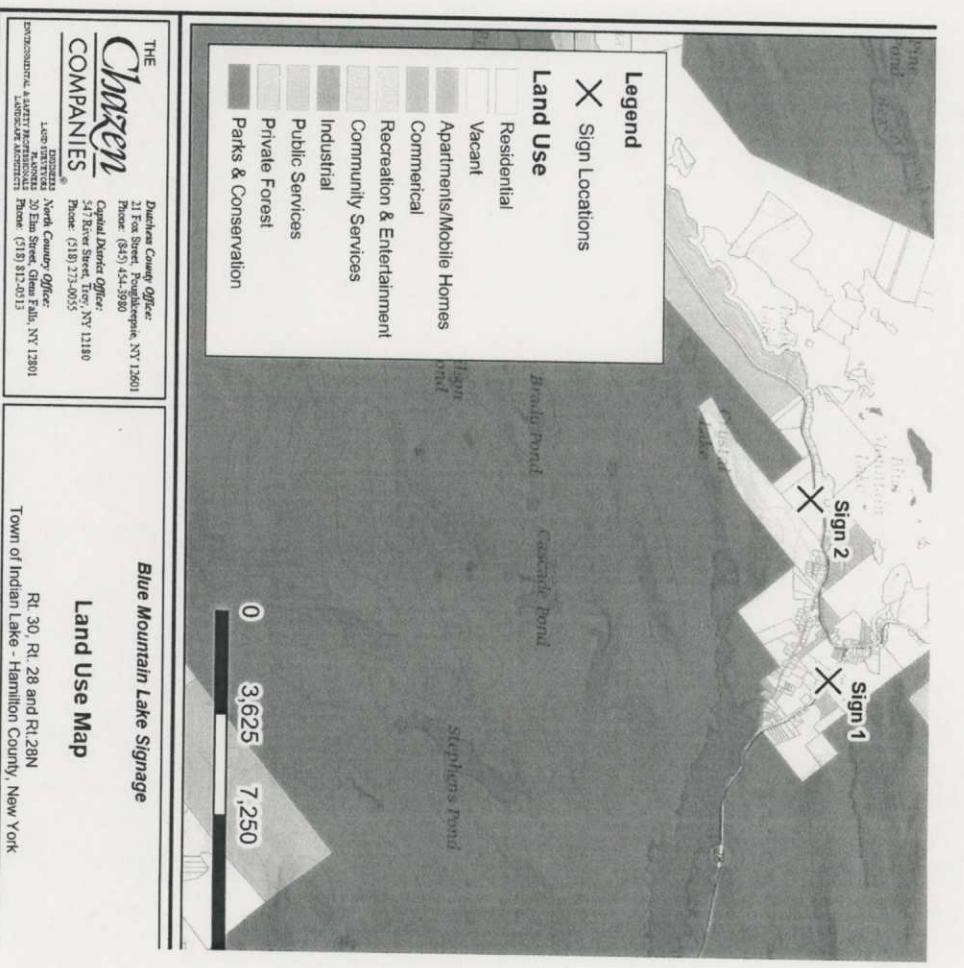
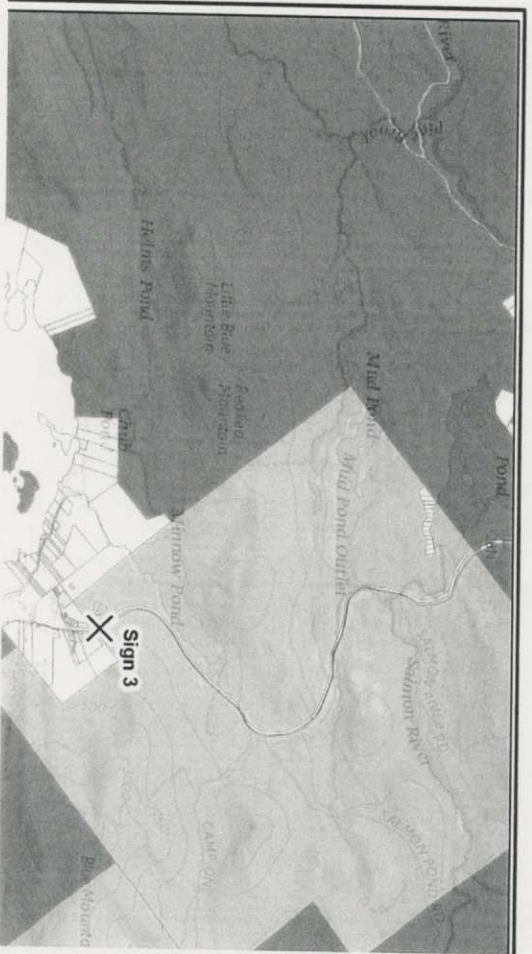

THE Chaspen COMPANIES
 LAND DEVELOPMENT AND SITE PREPARATION SERVICES
 INCORPORATED IN NEW YORK STATE
 1400 WESTCHESTER AVENUE, SUITE 200
 WESTCHESTER, NEW YORK 12591-2000
 Phone: (518) 312-0113

Dutchess County Office:
 21 Fox Street, Poughkeepsie, NY 12601
 Phone: (845) 454-3980

Capital District Office:
 547 River Street, Troy, NY 12180
 Phone: (518) 273-0055

North County Office:
 20 Elm Street, Otisville, NY 12851
 Phone: (518) 312-0113

Blue Mountain Lake Signage
Land Use Map
 RI, 30, RI, 28 and RI, 28N
 Town of Indian Lake - Hamilton County, New York

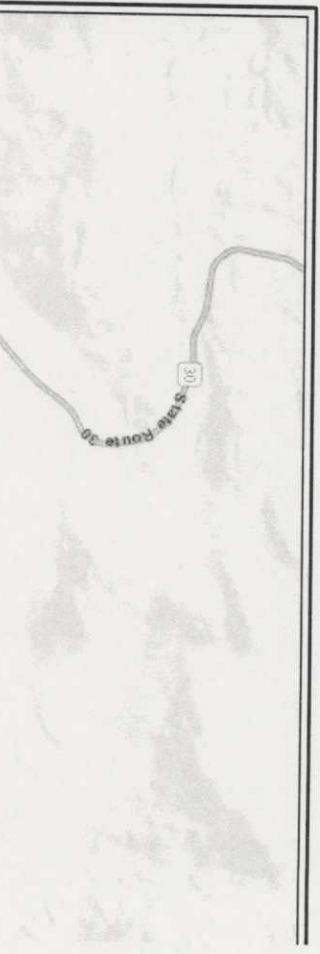

- Project Site
- Consultation Projects
- Survey Archaeology
- Areas
- Archeologically Sensitive Areas
- National Register Building Listing



Blue Mountain Lake Signage

NYSOPRHP Cultural Resource Information System (CRIS) Map

Town of Indian Lake - Hamilton County, NY

THE Chazen COMPANIES
 DIRECTOR OF ENVIRONMENTAL & SUSTAINABLE PERFORMANCE
 LANSING, MI 48106
 PHONE: (313) 812-0111

Dutchess County Office:
 21 Fox Street, Poughkeepsie, NY 12601
 Phone: (845) 454-5980

Capital District Office:
 547 River Street, Troy, NY 12180
 Phone: (518) 273-0855

North County Office:
 20 Elm Street, Great Falls, NY 12801
 Phone: (518) 812-0111

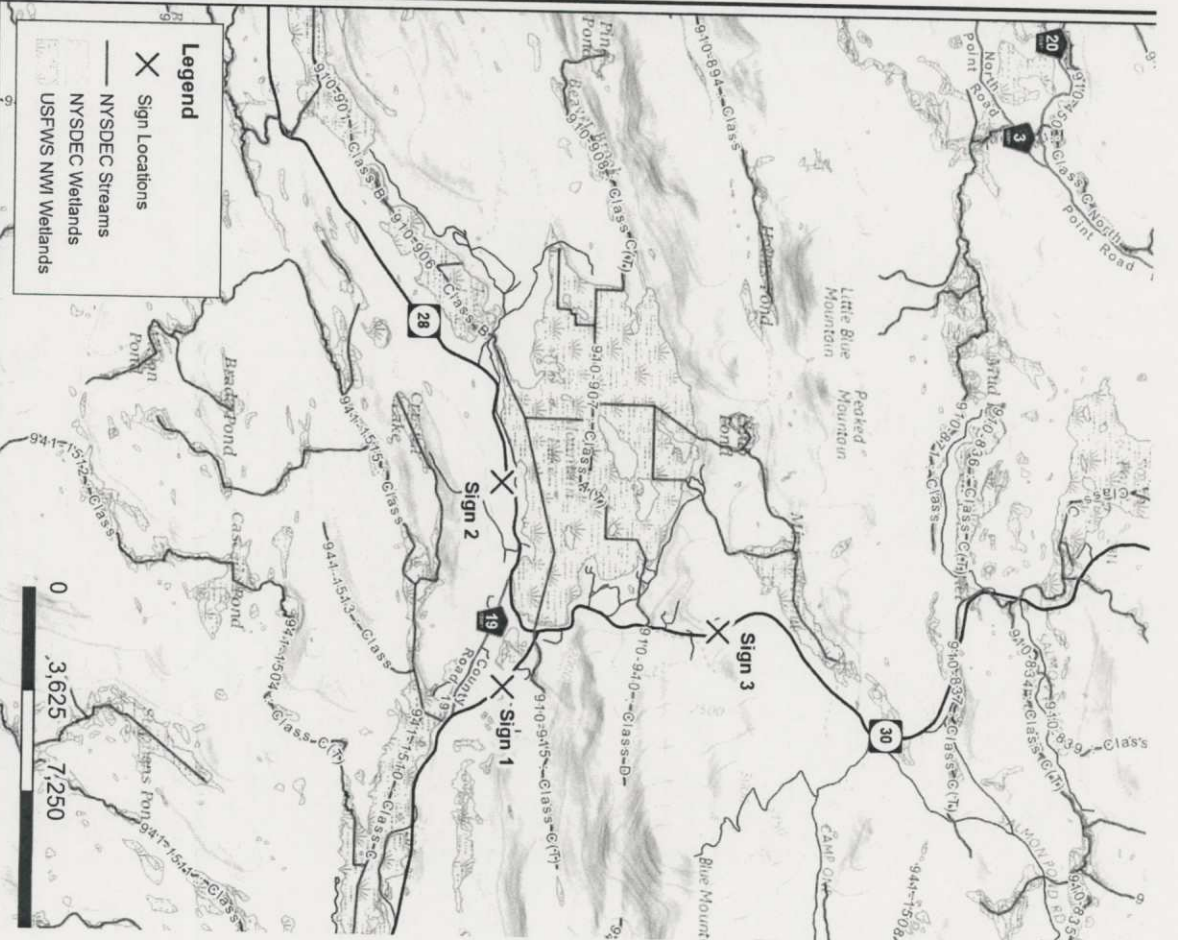

- Legend**
- Sign Locations
 - NYSDEC Streams
 - NYSDEC Wetlands
 - USFWS NMI Wetlands



Blue Mountain Lake Signage

Wetland and Water Resources

RI 30, RI 28 and RI 28N
 Town of Indian Lake - Hamilton County, New York

THE Chazen COMPANIES
 DIRECTOR OF ENVIRONMENTAL & SUSTAINABLE PERFORMANCE
 LANSING, MI 48106
 PHONE: (313) 812-0111

Dutchess County Office:
 21 Fox Street, Poughkeepsie, NY 12601
 Phone: (845) 454-5980

Capital District Office:
 547 River Street, Troy, NY 12180
 Phone: (518) 273-0855

North County Office:
 20 Elm Street, Great Falls, NY 12801
 Phone: (518) 812-0111

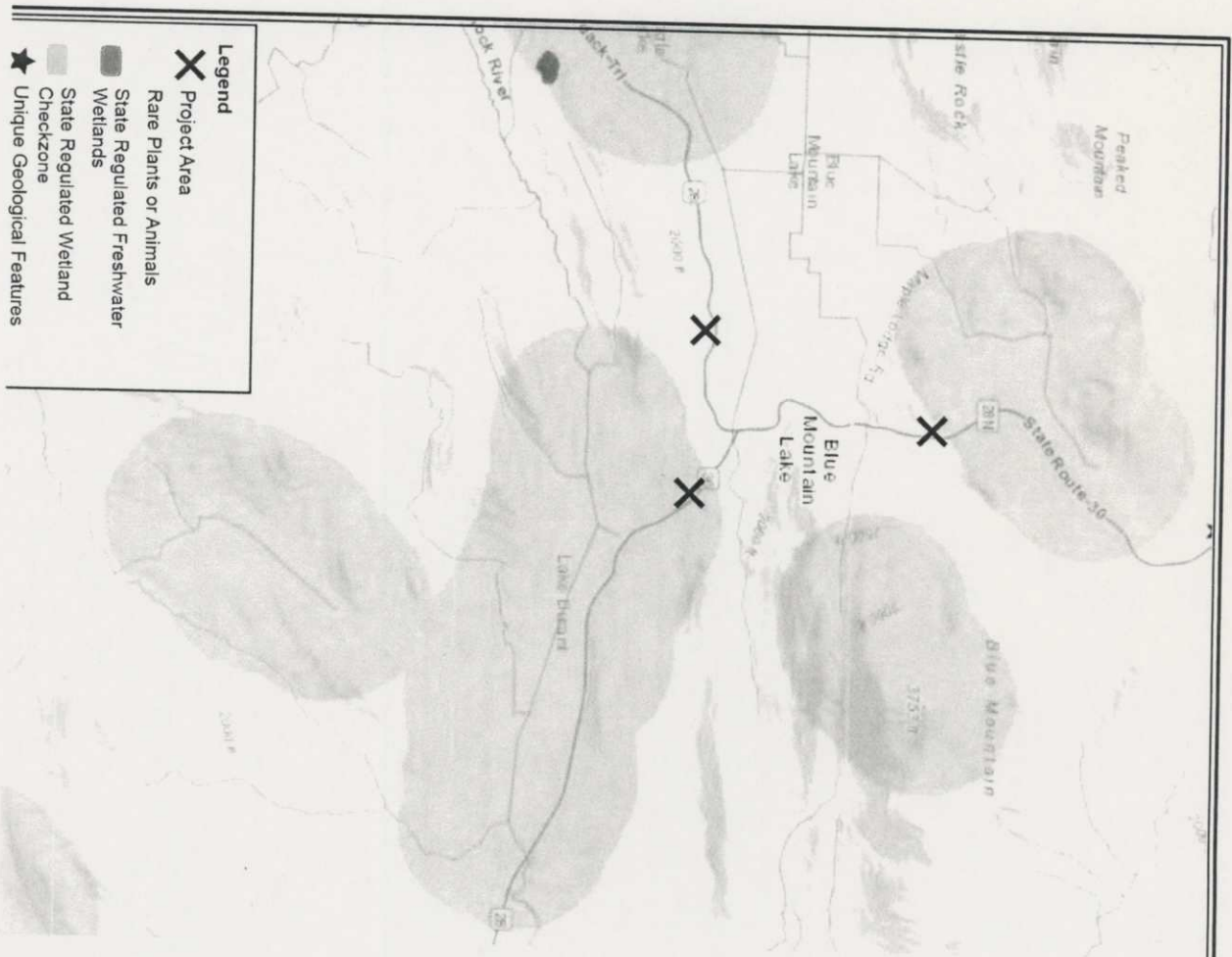

<p>THE Chazen COMPANIES</p> <p><small>INCORPORATED IN NEW YORK STATE ENVIRONMENTAL ANALYSIS PROGRAMS LICENSED BY THE STATE OF NEW YORK</small></p>		<p>Dutchess County Office: 21 Fox Street, Poughkeepsie, NY 12601 Phone: (845) 454-3980</p>
<p>Capital District Office: 547 River Street, Troy, NY 12180 Phone: (518) 273-0035</p>	<p>NYSDEC Environmental Resource Map</p>	<p>Rock County Office: 20 Elm Street, Hamilton, NY 12801 Phone: (518) 812-0515</p>
<p>Blue Mountain Lake Signage</p> <p>Town of Indian Lake, Hamilton County, NY</p>		

**Short Environmental Assessment Form
Part 2 - Impact Assessment**

Agency Use Only (If applicable)
Project: _____
Date: _____

Part 2 is to be completed by the Lead Agency.
Answer all of the following questions in Part 2 using the information contained in Part 1 and other materials submitted by the project sponsor or otherwise available to the reviewer. When answering the questions the reviewer should be guided by the concept "Have any responses been reasonable considering the scale and context of the proposed action?"

	No, or small impact may occur	Moderate to large impact may occur
1. Will the proposed action create a material conflict with an adopted land use plan or zoning regulations?	<input checked="" type="checkbox"/>	<input type="checkbox"/>
2. Will the proposed action result in a change in the use or intensity of use of land?	<input checked="" type="checkbox"/>	<input type="checkbox"/>
3. Will the proposed action impair the character or quality of the existing community?	<input checked="" type="checkbox"/>	<input type="checkbox"/>
4. Will the proposed action have an impact on the environmental characteristics that caused the establishment of a Critical Environmental Area (CEA)?	<input checked="" type="checkbox"/>	<input type="checkbox"/>
5. Will the proposed action result in an adverse change in the existing level of traffic or affect existing infrastructure for mass transit, biking or walkway?	<input checked="" type="checkbox"/>	<input type="checkbox"/>
6. Will the proposed action cause an increase in the use of energy and it fails to incorporate reasonably available energy conservation or renewable energy opportunities?	<input checked="" type="checkbox"/>	<input type="checkbox"/>
7. Will the proposed action impact existing: a. public / private water supplies? b. public / private wastewater treatment utilities?	<input checked="" type="checkbox"/>	<input type="checkbox"/>
8. Will the proposed action impair the character or quality of important historic, archaeological, architectural or aesthetic resources?	<input checked="" type="checkbox"/>	<input type="checkbox"/>
9. Will the proposed action result in an adverse change to natural resources (e.g., wetlands, watersheds, groundwater, air quality, flora and fauna)?	<input checked="" type="checkbox"/>	<input type="checkbox"/>
10. Will the proposed action result in an increase in the potential for erosion, flooding or drainage problems?	<input checked="" type="checkbox"/>	<input type="checkbox"/>
11. Will the proposed action create a hazard to environmental resources or human health?	<input checked="" type="checkbox"/>	<input type="checkbox"/>

**Short Environmental Assessment Form
Part 3 Determination of Significance**

Agency Use Only (If applicable)
Project: _____
Date: _____

For every question in Part 2 that was answered "moderate to large impact may occur", or if there is a need to explain why a particular element of the proposed action may or will not result in a significant adverse environmental impact, please complete Part 3. Part 3 should, in sufficient detail, identify the impact, including any measures or design elements that have been included by the project sponsor to avoid or reduce impacts. Part 3 should also explain how the lead agency determined that the impact may or will not be significant. Each potential impact should be assessed considering its setting, probability of occurring, duration, irreversibility, geographic scope and magnitude. Also consider the potential for short-term, long-term and cumulative impacts.

The proposed project is not anticipated to have any significant adverse environmental impacts. The proposed signs will have the same footprint (20 square feet for each sign) as the current signs. The proposed signs will have 12"10" tall posts with two panels, one being 4.5' x 5' and one being 4.5' x 1'. The signs will be made of painted wood or 16gg aluminum with matte over laminate.

The purpose of the signs is to provide way-finding for visitors and to attract tourism to the area and its attractions. The signs are proposed for the following locations: (1) Rt. 30 coming from the hamlet of Indian Lake, (2) Rt. 28 coming from Inlet/Old Forge, and (3) Rt. 28N coming from Long Lake, and . All three signs will have the same artwork and wording. They will say "Blue Mountain Lake, Home of the Adirondack's Largest Museum and the Adirondack's Oldest Arts Center".

Check this box if you have determined, based on the information and analysis above, and any supporting documentation, that the proposed action may result in one or more potentially large or significant adverse impacts and an environmental impact statement is required.

Check this box if you have determined, based on the information and analysis above, and any supporting documentation, that the proposed action will not result in any significant adverse environmental impacts.

Town of Indian Lake _____ Date 6-8-2020

Name of Lead Agency _____ Title of Responsible Officer _____

Brian Wells _____ Title of Responsible Officer _____

Print or Type Name of Responsible Officer in Lead Agency _____

Signature of Responsible Officer in Lead Agency _____ Signature of Preparer (if different from Responsible Officer) _____

Julie A. Cannon
Notary of Rethel/Ann Carr 6/8/2020

Passed
Tune George
Meeting

Blue Mountain Lake

Jessica Leerkes <jleerkes@cedarwoodengineering.com>

Fri 6/5/2020 1:01 PM

To: Brian Wells <ilsuper@hotmail.com>

Cc: Bob Murray <bmurray@d hazencompanies.com>; Jonathan Soukup <jsoukup@cedarwoodengineering.com>

1 attachments (60 KB)

Blue Mountain Lake Proposal 4-16-20.pdf

Brian,

We received a quote from HydroSource to work as a subcontractor to us to do some additional site investigation. I have attached the proposal. We just wanted to touch base and make sure you were okay with us moving forward with HydroSource. Their fees would come out of our contract and we'll be including all of the appropriate EFC bid packets so that it is reimbursable. If you are good with us moving forward with HydroSource, just send me an email or give me a call (518-338-5548). As soon as we hear from you we'll put together our contract documents with HydroSource and they'll get moving on the work. They did say that their work shouldn't take a long time and then we could hopefully have a conference call with all parties to discuss their findings.

On a different note, the EFC did touch base with us about a week ago, checking on status of contracts and applications, so I also thought I'd see if the Town needed any additional help on the SRF application. I've copied Bob from Chazen on this email to make sure he's in the loop on everything. If you need anything from either of us, please let us know.

Thank you,

Jessica Leerkes



3903 Main Street
Warrensburg, NY 12885
P. 518 623 5500
F. 518 623 5503

PROPOSAL
TO
CEDARWOOD ENGINEERING & ENVIRONMENTAL SERVICES, PLLC
FOR
HIGH-YIELD WELL SITTING HYDROGEOLOGIC EVALUATION
BLUE MOUNTAIN LAKE WATER DISTRICT
TOWN OF INDIAN LAKE, NEW YORK

April 16, 2020

INTRODUCTION

HydroSource Associates, Inc. (HSA) is pleased to present the following proposal to provide professional hydrogeological services and groundwater source location and well-siting work as the initial stage of an overall project to develop a new supply of groundwater for Cedarwood Engineering's client, the Blue Mountain Lake Water District in the Town of Indian Lake, New York. The proposed scope of work includes conducting a detailed hydrogeologic evaluation of an area within a reasonable distance of the public water distribution system with the objective of identifying specific "Favorable Zones" that are likely to possess promising physical and hydrogeological characteristics for the development of a sustainable high-yield well source of good quality water (i.e., water that would require little or no treatment), as well as the necessary features that meet NYSDOH well siting requirements.

Specifically, HSA's goal would be to identify locations that maximize the likelihood of developing a groundwater source of sufficient yield, adequate long-term recharge to sustain indefinite water extraction, appropriate water quality, that is protected from sources of potential contamination, that will meet State of New York public drinking water well source requirements, and that is as close to the District's water system as possible.

PROPOSED SCOPE OF WORK

Groundwater source development is commonly carried out in a series of steps, with an appropriate pause between each to discuss results and decide on whether and how to best proceed with subsequent efforts. The first step typically involves conducting an initial hydrogeologic evaluation of an assigned study area. The purpose of this effort is to identify limited-size sites (Favorable Zones) where groundwater development potential appears best. A range of factors that control groundwater development potential are considered. These include: bedrock and surficial geology; structural geology; watershed size and recharge potential; contaminant threats; and practical considerations like proximity to the distribution system and setbacks from property lines. The work product from the first phase is a brief progress report summarizing the pertinent site-specific conditions of areas considered candidate locations for potential well development, and a set of recommendations for proceeding with well siting and installation based on those site conditions.

Specific tasks we propose for the present effort are as follows.

Task 1 - Information Review: An initial task will be to obtain and review readily available background information on the local hydrogeology. HSA will review pertinent previous work performed in the area related to groundwater resources. Specifically, this would include available information, reports and other pertinent information generated by prior geologic or water-related efforts in and around the District area. The review will include an evaluation of information such as surficial geologic maps, bedrock geologic maps, New York State Geologic Survey reports, local engineering reports, and United States Geological Survey (USGS) studies. The study area will be limited to that which is within a reasonable distance of the water system.

Data that NYSDEC keeps on record from existing wells completed in the surrounding area will be collected and evaluated, as will information from past well installation attempts that have been made on behalf of the District. Information of interest will include total well depth, reported yield, depth to bedrock, water level depth, sediment descriptions, pumping test results, and water quality information. Well information can be useful in many ways. For example, wells with unusually long casing lengths indicate a substantial overburden thickness, suggesting the possibility of a greater-than-normal saturated thickness of overlying sediments (i.e., an over-deepened area, which may signify an area where an overburden aquifer could be present, or that the over-deepening was a result of the underlying bedrock being fractured and more prone to erosion). Well records may also list at what depth water-bearing sand and gravel deposits were encountered, which often allows us to assess the saturated thickness of the local sediments and predict where nearby the thickness of the deposits may be greatest. Sometimes it is noticed that all the bedrock wells within a short distance of a mapped lineament have higher-than-average reported yields, confirming that the lineament is the surface expression of an open, water-producing bedrock fracture zone.

Pertinent information, including bedrock and surficial geologic boundaries, well locations and data, etc., will be digitized, along with natural and cultural features, to develop a Geographic Information System (GIS) database, basemap and conceptual hydrogeologic model of the area. The GIS system will allow for the various sets of pertinent information to be superimposed upon one another, allowing analysis and identification of areas where the most favorable combination of features (in terms of productive well development) appear to be present. The GIS database that is created will be used both for analysis during the early phases, and can also be used to create maps needed later during the new groundwater source permitting process.

Task 2 - Lineament/Fracture Trace Analysis: Various forms of digital map and photographic imagery will be analyzed to assess the local structural setting as a means of identifying where over-deepened troughs and/or bedrock fracture zones are more likely to exist. Such structural features are often signified by lineaments. Lineaments, or "fracture traces", are linear or curvilinear features that can be recognized on aerial photographs, topographic maps, and other map-like products. Some lineaments are the surface expression of bedrock structures such as contacts between different rock types, faults, and fracture zones. They can also be indicative of the presence of over-deepened valleys that may possess thicker overburden sediments. Wells drilled near such features tend to have higher yields than other wells. For this effort, we will analyze and map lineaments using a combination of Digital Elevation Model (DEM) data. Light

Detection and Ranging (LiDAR) imagery, and/or high-altitude, color infrared, stereographic aerial photography covering the subject area.

When viewed with appropriate software, DEM and LiDAR data provide multiple three-dimensional perspectives on topography, geomorphology, hydrology, and structure that cannot be obtained from study of conventional topographic maps or air photos. These data formats allow simulation of the way the land surface would appear if it were illuminated by an artificial light source shining from a designated compass direction and angle above the horizon. Varying the light angle accentuates linear features at different orientations, and allows recognition of linear features that might be missed on air photos, in which the ground surface is necessarily illuminated only by "natural" sun angles. They make it possible to study areas from many different perspectives. Combining the three-dimensional perspectives with two-dimensional layers, such as geologic maps, often allows an analyst to refine previously mapped information and identify areas of heightened groundwater development potential, and identify more precisely the ground-location of mapped or previously unidentified bedrock contacts, faults and/or fracture networks, i.e., areas of heightened groundwater development potential.

Lineaments mapped using the chosen image variants will be consolidated for interpretation. Interpretation involves assessing the relative strength and frequency of lineaments at various orientations. It also involves recognizing lineament families, which are sets of parallel lineaments with similar characteristics. Lineaments that are members of such families are more likely than "stray" lineaments to represent systematic weaknesses in the underlying bedrock. Some of the mapped lineaments, or lineament intersections, would then be targeted for geophysical surveying and drilling of wells.

Task 3 - Contaminant Threats Check: We will conduct a brief search for potential sources of contamination within the area so that we avoid wasting exploration efforts on areas with a high risk of groundwater contamination, and areas for which regulatory approval would be difficult. This would involve a query of NYSDEC databases holding information on such items as past chemical spills, leaking underground storage tanks, landfills, junkyards, open-air road salt stockpiles, and the like. The main consequence of this work would be to avoid drilling a well in an area that ultimately could not be approved or that would be at an unacceptable risk of future contamination.

Task 4 - Assessment of Available Recharge and Storage: HSA will qualitatively assess whether there is likely to be sufficient available groundwater recharge to candidate areas for possible well development to sustain the rate of groundwater extraction sought. To estimate recharge, HSA takes into account the amount of rainfall, the size of the relevant watershed area upgradient of a candidate area, and the areal distribution and infiltration capacities of the various soils within that watershed to calculate the volume of renewable water available. The groundwater recharge assessment is used to confirm that there should be sufficient recharge to support the rate of groundwater withdrawal needed, and that it may be sustainably extracted on an indefinite basis without creating adverse impacts. This is performed in the early stages of a project to ensure there is sufficient available water before further investment in any particular area is made.

Task 5 - Site Inspection: A field visit and site inspection will be performed, during which local bedrock outcrops and exposures of surficial sediments are examined, the geology indicated by published sources would be field-checked, and more-specific information on the bedrock and surficial geology of the area not available from regional-scale geologic maps will be sought. The location and orientation of prominent fractures observed in local bedrock exposures will be mapped to identify where they may trend into areas where other favorable well-siting characteristics coincide. The banks of local creeks will also be inspected to assess depth and thickness of local overburden deposits, and areas mapped as being underlain by sand and gravel will be checked to evaluate the likely saturated thickness and recharge characteristics.

Individual sites that had been identified as having special interest based on review of the background data will be inspected. Observations/assessments will also be made regarding the practical aspects of well-siting and installing wells at potential candidate sites.

A meeting with Cedarwood and/or District officials can also be arranged during this trip to review the tasks, site and project information.

Task 6 - Identification of Promising Areas for Groundwater Development/Report: The result of the work described above will be the identification of one or more Favorable Zones, expected to be areas of up to several acres in size, proximal to the water system, that possess potential for overlying geologic environments where high-yield wells that satisfy applicable regulatory requirements may be located. These areas will be shown on a map submitted to Cedarwood Engineering along with a brief report summarizing our conclusions and recommendations for proceeding with further work.

Typically, multiple Zones are identified. If more than one area is identified, we will rank them in the order of their perceived yield potential. These rankings will be based upon our evaluation of geologic and hydrogeologic characteristics, including geologic structure, recharge potential, aquifer storage, geomorphology, soil type, permeability, and site location with respect to contaminant threats. A number of options will be beneficial in the event that some Zones are inaccessible for whatever reason (e.g., uncooperative landowner, Cedarwood or its client may determine that some Zones are undesirable for engineering or other reasons). Properties already owned or controlled by the Town or District will also be considered as possible candidate sites; however, if other areas appear to offer greater potential to develop more productive and/or higher quality water sources, we will make the appropriate recommendations. Generally, HSA will search for candidate sites for proposed well source development at which the range of pertinent qualities are optimized.

Discussions will be held with Cedarwood and water system officials to review our results and recommendations, answer any questions, and to decide if and within which areas further groundwater source siting and development work is to be focused.

TOTAL NOT TO EXCEED COST

\$7,950

Re: New transfer hours are not 2nd home owner friendly

Brian Wells <lisuper@hotmail.com>

Tue 5/26/2020 12:17 PM

To: John@speedwaypress.com <John@speedwaypress.com>

John

Thank you for your very informative e-mail. As we all struggle to deal with the Coronavirus changes we implemented to protect all residents of Indian Lake. There was no distinction between year round or seasonal. We also attempted to protect the people who worked at the transfer station. We are looking to go back to our regular hours starting June 1st. This is the first time I have had anyone bring up the option of switching days from Friday to Monday, I think there may be a value to look into this. Finally thank you for adding " respectfully request" to your e-mail as it was the only part that was respectful.

Brian E Wells - Supervisor
Town of Indian Lake

From: John M. Henry <John@mpcnyc.com>

Sent: Tuesday, May 26, 2020 12:00 PM

To: lisuper@hotmail.com <lisuper@hotmail.com>; indianlakechamber@frontier.net <indianlakechamber@frontier.net>

Subject: New transfer hours are not 2nd home owner friendly

We have been an Indian Lake property owner since 1985. Over the years, I have seen things done that make no sense in making Indian Lake a welcoming community to seasonal residents or vacationers. Changing the transfer hours to eliminate Sunday is the latest one. A 2 to 5 hour drive with trash in our car on the way home is not enjoyable, especially in the hot summers. Since we respect the Adirondacks, we would never think of leaving our trash week to week, but, unfortunately, I am in the minority.

With Hamilton county the #1 county of second home owners in the USA, you should be doing all you can to foster people wanting to be here. With over 75% of the total tax levy coming from non-residents, you would think we would get some consideration. You know we all leave on Sunday afternoon to go back to our jobs which allow us to shoulder your tax burden. You know we will have no option on the trash other than to leave it or ride home with it.

Add in you have the lake area trash pick-up on Friday, but the village is Monday?? Why not flip that so weekenders can take advantage of what their taxes pay the majority of? With the increase in weekend rentals, I predict you see more trash left out to pick up day. Or people getting frustrated and leaving their trash outside the gate on Sunday. Can't wait to see you having to deal with not only scattered trash on Monday mornings, but nuisance bears as well finding a buffet and a new residence in Indian Lake.

I have never believed the feeling of many seasonal owners this is all deliberate to cost shift or cut costs at the expense of we who have no vote. Now I have to

wonder. For all the years I am have been coming, we make an effort to buy local, to contribute to the Fire and Ambulance drives, to make sure our property is clean and secured. I now find myself saying why bother when the town leaders don't respect our needs...only our dollars.

I would respectfully request that you change the transfer hours back to being open on Sunday, at least from May through October, to accommodate those of us who can't be there on Monday or Friday.

John M. Henry

Speedway Press • Mitchell Printing & Mailing Inc. •The Phoenix Press
1 Burkle Street
Oswego NY 13126
315-343-3531

**TOWN OF INDIAN LAKE
BUDGET TRANSFERS**

6/8/2020

<u>TO</u> ADULT RECREATION -C ZONING-C	<u>GENERAL FUND</u>	<u>ACCT #</u> A.7620.400 A.8010.400	<u>PRIOR BUDGET AMT</u> \$41,000.00 \$1,000.00	<u>THIS REQUEST</u> \$10,000.00 \$6,000.00	<u>ADJUSTED BUDGET</u> \$51,000.00 \$7,000.00
--	---------------------	---	--	--	---

REASON FOR REQUEST
GROOMER REPAIRS WERE SUBSTANTIAL
ZONING UPDATE HIGHER THAN EXPECTED

<u>TOTAL FROM RETIREMENT CONTINGENT TOTAL</u>		<u>A.9010.800</u> <u>A.1990.400</u>	<u>\$116,000.00</u> <u>\$13,000.00</u>	<u>-\$3,000.00</u> <u>-\$13,000.00</u> <u>-\$13,000.00</u>	<u>\$16,000.00</u> <u>\$113,000.00</u> <u>\$0.00</u>
---	--	--	---	--	--

<u>TO UNEMPLOYMENT</u>	<u>HIGHWAY</u>	<u>ACCT #</u> DA.9050.800	<u>PRIOR BUDGET AMT</u> \$0.00	<u>THIS REQUEST</u> \$5,000.00	<u>ADJUSTED BUDGET</u> \$5,000.00
------------------------	----------------	------------------------------	-----------------------------------	-----------------------------------	--------------------------------------

EMPLOYEE GETTING UNEMPLOYMENT - WASNT HIRED BACK IN 2019-2020

<u>TOTAL FROM MACHINERY-C TOTAL</u>		<u>DA.5130.400</u>	<u>\$205,000.00</u>	<u>\$5,000.00</u> <u>-\$5,000.00</u> <u>-\$5,000.00</u>	<u>\$200,000.00</u>
-------------------------------------	--	--------------------	---------------------	---	---------------------

DIDNT RUN EQUIPMENT FOR OVER A MONTH

Shirley C. Dean
File Maloney 6/8/20
John F. Butler 6/9/20

TOWN OF INDIAN LAKE BUDGET TRANSFERS

6/8/2020

<u>TO</u>	<u>GENERAL FUND</u>	<u>PRIOR BUDGET AMT</u>	<u>THIS REQUEST</u>	<u>ADJUSTED BUDGET</u>
ADULT RECREATION -C	ACCT # A.7620.400	\$41,000.00	\$10,000.00	\$51,000.00
ZONING-C	A.8010.400	\$1,000.00	\$6,000.00	\$7,000.00

REASON FOR REQUEST
GROOMER REPAIRS WERE SUBSTANTIAL
ZONING UPDATE HIGHER THAN EXPECTED

TOTAL FROM RETIREMENT CONTINGENT TOTAL	A.9010.800 A.1990.400	\$116,000.00 \$13,000.00	-\$3,000.00 -\$13,000.00	\$116,000.00 \$0.00
--	--------------------------	-----------------------------	-----------------------------	------------------------

<u>TO</u>	<u>HIGHWAY</u>	<u>PRIOR BUDGET AMT</u>	<u>THIS REQUEST</u>	<u>ADJUSTED BUDGET</u>
UNEMPLOYMENT	ACCT # DA.9050.800	\$0.00	\$5,000.00	\$5,000.00

EMPLOYEE GETTING UNEMPLOYMENT- WASNT HIRED BACK IN 2019-2020

TOTAL FROM MACHINERY-C TOTAL	DA.5130.400	\$205,000.00	-\$5,000.00 -\$5,000.00	\$200,000.00
------------------------------	-------------	--------------	----------------------------	--------------

DIDNT RUN EQUIPMENT FOR OVER A MONTH

Bruce Wells

**CITIZEN OF THE YEAR
RESOLUTION # 9 – IN THE YEAR 2020**

**Resolution offered by: Supervisor Brian Wells
Seconded by: Councilwoman Sally Stanton, Councilwoman Patricia Ryan-Curry, Councilman John Rathbun and Councilman Jake Mahoney**

WHEREAS: The Town Board of the Town of Indian Lake yearly honors a Citizen of Indian Lake, who through deeds and service to their community goes above and beyond to the betterment of their community, **AND**

WHEREAS: This year of 2020 has been a precedent setting year of challenges and hardships to the Community, State and Nation, **AND**

WHEREAS: The Volunteers of the community of Indian Lake have shown resilience, tenacity, fortitude, and compassion to their fellow residents and to their community, **AND**

WHEREAS: The Town Board of the Town of Indian Lake wishes to bestow to all its Volunteers, the title of "Citizen of the Year" **AND**

WHEREAS: The Citizen of the Year Plaque located in the Town Hall will be engraved for the year 2020 with Indian Lake Volunteers to forever document the efforts of the Volunteers of Indian Lake

RESOLVED: that on this day of June 8, 2020, the Town Board of the Town of Indian Lake do hereby recognize, thank and commend the "Volunteers of Indian Lake" commitment and dedication to the Town of Indian Lake and Blue Mountain Lake, **AND BE IT FURTHER,**

RESOLVED: that this Resolution #9 in the year 2020 be put in the Official Minutes and Official Resolution Book of the Town of Indian Lake.

BY ORDER OF THE TOWN BOARD OF THE TOWN OF INDIAN LAKE

**State of New York
County of Hamilton
Town of Indian Lake**

I, **Julie A. Clawson, Town Clerk** of the Town of Indian Lake do hereby certify that **Resolution # 9, in the year 2020**, was duly adopted by the Town Board of the Town of Indian Lake, Hamilton County, New York State at the Town Board meeting held in Indian Lake on June 8, 2020.

Resolution # 9 will be on file in the Resolution Book as well as the Official Minutes in the Town Clerks office at the Town Hall, located on Pelon Road, Town of Indian Lake, County of Hamilton, and State of New York.

The following Board Members of the Indian Lake Town Board had due notice of the meeting and was present at said meeting: **Supervisor Brian Wells, Councilwoman Sally Stanton, Councilwoman Patricia Ryan-Curry, Councilman John Rathbun and Councilman Jake Mahoney**

IN WITNESS WHEREOF, I have hereunto set my hand and the seal of the Town of Indian Lake on this 9th day of June, 2020.

Seal

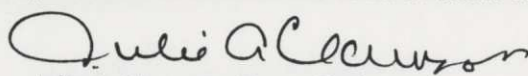
Julie A. Clawson - Town Clerk

Executive Session

Supervisor Wells called for an Executive Session at 8:43 p.m. for the purpose of discussing Contractual obligations. Seconded by, Councilman Rathbun. All in favor. Motion Carried.

Supervisor Wells made a motion to exit Executive Session at 10:05 p.m. Seconded by, Councilman Rathbun. All in favor Motion carried.

No action taken during Executive Session.

Councilman Mahoney made a motion to get an updated Title search done for the Adirondack One-Stop business loan. Seconded by, Supervisor Wells. All in favor. Motion carried.

Supervisor Wells made a motion to adjourn meeting at 10:10 p.m. Seconded by, Councilwoman Curry. All in favor. Meeting adjourned.

Respectfully Submitted by:

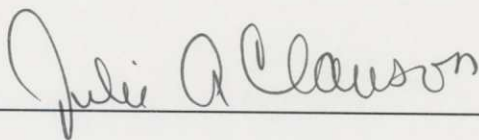

Town Clerk